

SC18G

Universal Compressor

R134a

220-240V 50Hz

Data Sheet (Replaces CD.44.V2.02)

General

Compressor	SC18G
Code number	104G8820
Code number	104G8822
Code number compressor with oil cooler	104G8830

Application

Application		LBP/HBP
Evaporating temperature range	°C	-35 to 15
Voltage range	V/Hz	LBP: 187 - 254 /50
		LBP: 198 - 254 /60
		HBP: 198 - 254 /50
Motor type		CSIR
Max. ambient temperature	°C	43
Comp. cooling at ambient temp.	32°C	LBP: O/F ₁
		HBP: F ₂
	38°C	LBP: O/F ₁
		HBP: F ₂
43°C	LBP: O/F ₁	
	HBP: F ₂	

Design

Displacement	cm ³	17.69
Oil quantity	cm ³	550 (500 on comp. with oil cooler)
Maximum refrigerant charge	g	1300
Free gas vol. in compressor	cm ³	1460
Weight without electrical equipment	kg	13.7

Motor

Motor size	watt	495
LRA (rated after 4 sec. UL984) HST	A	18.6
Cut-in current HST	A	18.6
Resistance, main and start winding (25°C)	Ω	3.7/14.1
Approvals		EN 60335-2-34, CCIB

Dimensions

		104G8830	104G8820	104G8822
Height	mm	A	219	
		B	213	
		B1	193	
		B2	110	
Suction connector	location/I.D. mm	C	8.2 ±0.09	8.2 ±0.09
Process connector	location/I.D. mm	D	6.2 ±0.09	6.5 ±0.09
Discharge connector	location/I.D. mm	E	6.2 ±0.09	6.5 ±0.09
Oil cooler	location/I.D. mm	F	6.2 ±0.09	
Compressors on a pallet	pcs.		80	

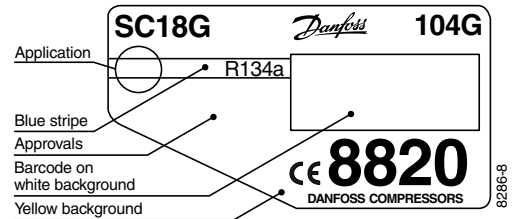

- S = Static cooling normally sufficient
- O = Oil cooling
- F₁ = Fan cooling 1.5 m/s
(compressor compartment temperature equal to ambient temperature)
- F₂ = Fan cooling 3.0 m/s necessary

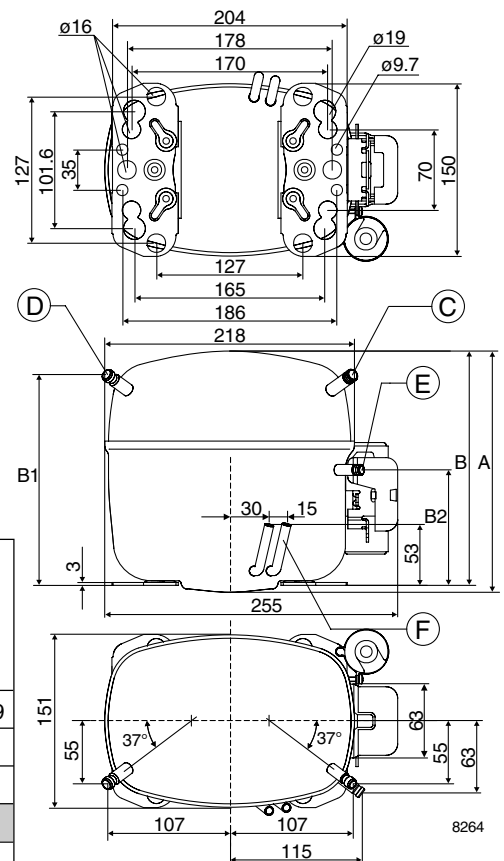

Capacity (EN 12900/CECOMAF)
watt

Comp.\°C	-25	-23.3	-20	-15	-10	-5	0	5	7.2	10	15
SC18G	283	318	394	526	684	870	1087	1337	1459	1624	1950

Capacity (ASHRAE)
watt

Comp.\°C	-25	-23.3	-20	-15	-10	-5	0	5	7.2	10	15
SC18G	348	392	485	649	844	1074	1343	1655	1807	2014	2423

Power consumption
watt

Comp.\°C	-25	-23.3	-20	-15	-10	-5	0	5	7.2	10	15
SC18G	331	351	389	448	507	568	630	695	725	763	835

Current consumption
A

Comp.\°C	-25	-23.3	-20	-15	-10	-5	0	5	7.2	10	15
SC18G	2.56	2.62	2.72	2.88	3.05	3.24	3.46	3.71	3.84	4.00	4.34

COP (EN 12900/CECOMAF)
W/W

Comp.\°C	-25	-23.3	-20	-15	-10	-5	0	5	7.2	10	15
SC18G	0.86	0.91	1.01	1.18	1.35	1.53	1.72	1.92	2.01	2.13	2.34

COP (ASHRAE)
W/W

Comp.\°C	-25	-23.3	-20	-15	-10	-5	0	5	7.2	10	15
SC18G	1.05	1.12	1.25	1.45	1.67	1.89	2.13	2.38	2.49	2.64	2.90

Test conditions	EN 12900/CECOMAF	ASHRAE
Condensing temperature	55°C	55°C
Ambient and suction gas temp.	32°C	32°C
Liquid temperature	55°C	32°C
Fan cooling, 220V 50Hz		

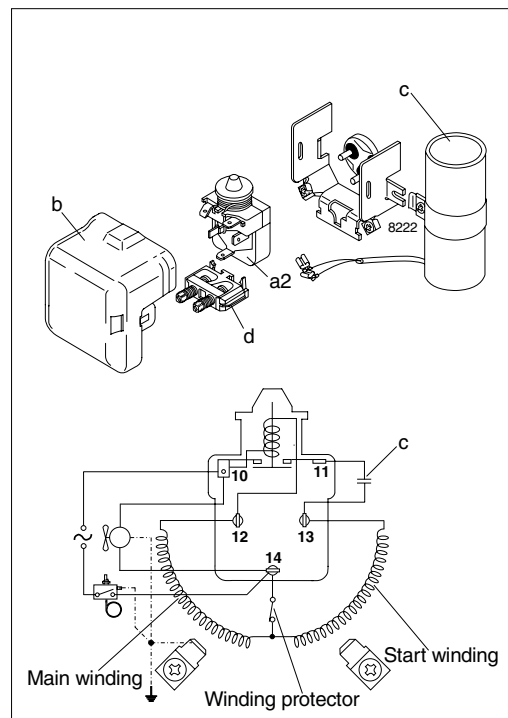
Accessories

Devices	Fig.	SC18G
Starting relay	a2	117U6019
Cover	b	103N2009
Starting capacitor 80 µF	c	117U5017
Cord relief	d	103N1004
Mounting accessories		
Bolt joint for one compressor		118-1917
Bolt joint in quantities		118-1918
Snap-on in quantities		118-1919