

ENGINEERING
TOMORROW

Danfoss

Catalogue | Standard MCHC condenser

Save time and money with **MCHC** standard products

Micro-Channel Heat Exchanger

70%

Lower refrigerant
charge

Initial and lifetime
costs are significantly
reduced

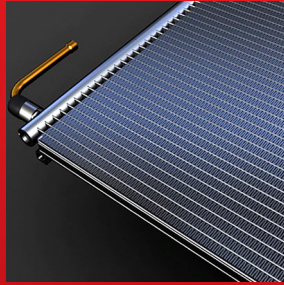



CONTENTS

Advantages – comparison with fin-tube heat exchanger	3
Standard specification	4
Common working conditions	5
D1000-c condenser coil	6
D1100-c condenser coil	8
D1200-c condenser coil	10
D1300-c condenser coil	12
D1400-c condenser coil	14
D1500-c condenser coil	16
D1600-c condenser coil	18
D1700-c condenser coil	20
D1800-c condenser coil	22
D1900-c condenser coil	24
D2000-c condenser coil	26

Advantages – Comparison with Fin-Tube Heat Exchanger

- 1 Greater refrigerant-side heat transfer efficiency
- 2 Greater air-side heat transfer efficiency
- 3 Lower hold-up volumes and refrigerant charge
- 4 Compact design and light weight
- 5 Better corrosion characteristic
- 6 Lower noisy levels
- 7 Brazed tube to fin joint
- 8 Easy cleaning

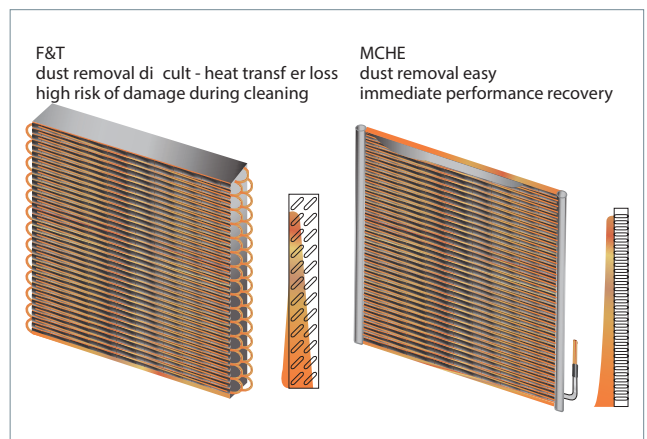
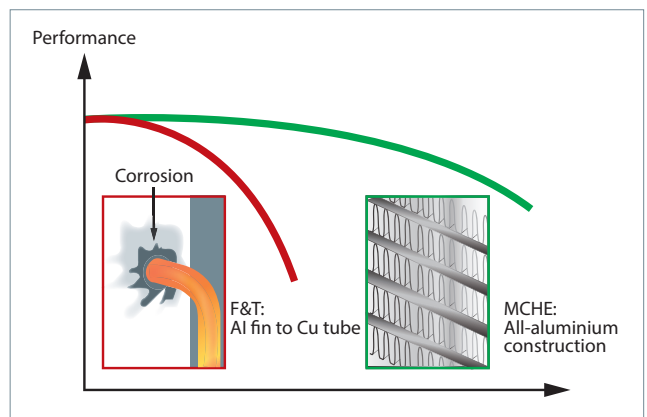
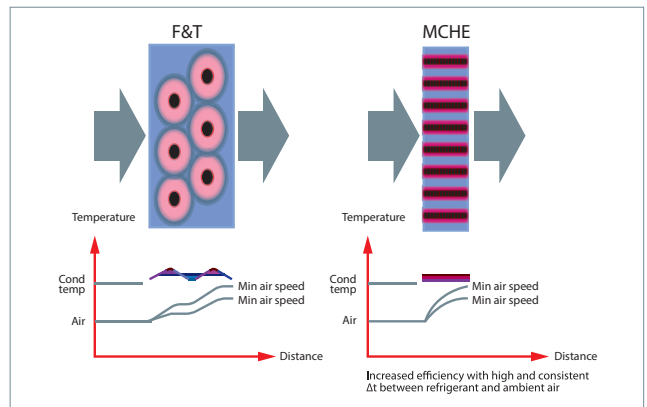
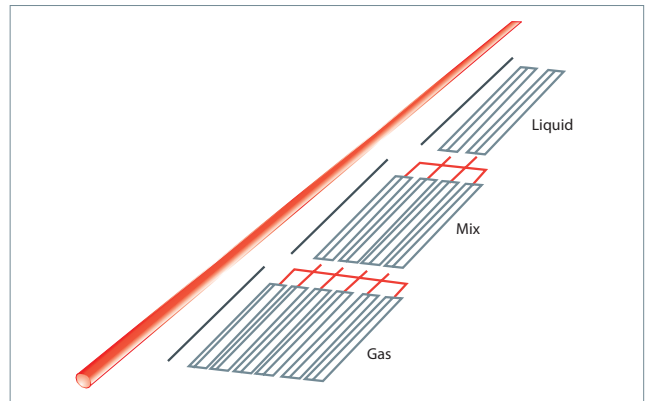

Standard Specification

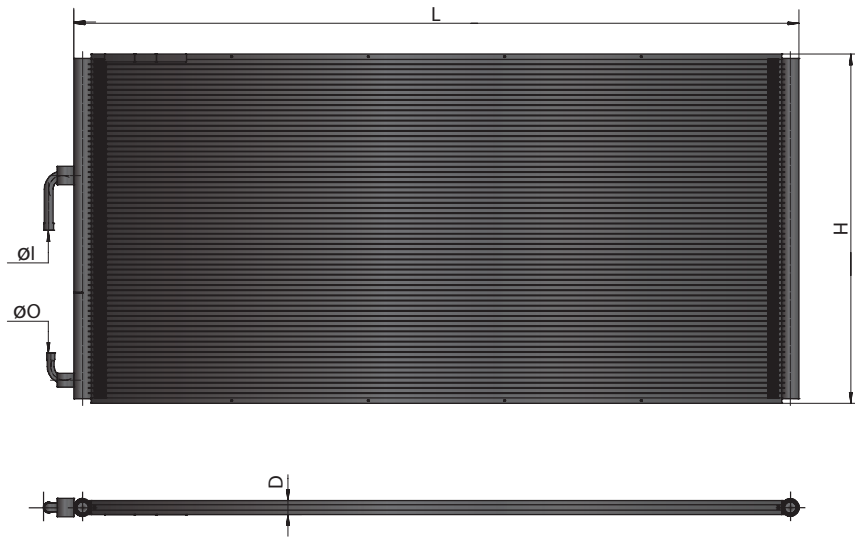

Standard Type	Total Length	Total Height	Tube Width	Inlet ID	Outlet ID	Coil Weight	Page
	[L]	[H]	[D]	[Φ]	[ΦO]		
	[mm/in]	[mm/in]	[mm/in]	[mm/in]	[mm/in]	[KG/LB]	
D1000-C	332/13.07	300.7/11.84	16/0.63	6.15/0.24	6.15/0.24	0.823/1.81	6
D1100-C	387/15.24	347.7/13.69	16/0.63	6.15/0.24	6.15/0.24	1.071/2.36	8
D1200-C	462/18.19	432.3/17.02	16/0.63	8.2/0.32	6.15/0.24	1.534/3.37	10
D1300-C	552/21.73	516.9/20.35	16/0.63	9.7/0.38	8.2/0.32	2.22/4.88	12
D1400-C	800/31.5	770.7/30.34	16/0.63	9.7/0.38	9.7/0.38	4.51/9.92	14
D1500-C	1074/42.28	516.9/20.35	25.4/1	12.9/0.51	12.9/0.51	6.515/14.33	16
D1600-C	1300/51.18	639.1/25.16	16/0.63	12.9/0.51	12.9/0.51	6.012/13.23	18
D1700-C	1324/52.13	639.1/25.16	25.4/1	16.1/0.63	12.9/0.51	9.777/21.51	20
D1800-C	1074/42.28	1212.5/47.74	25.4/1	22.4/0.88	22.4/0.88	15.139/33.31	22
D1900-C	1274/50.16	1362.9/53.66	25.4/1	22.4/0.88	22.4/0.88	19.88/43.74	24
D2000-C	2000/78.74	1058.3/41.67	25.4/1	25.4/1(OD)	22.4/0.88	26.273/57.8	26

Common Working Conditions

Working conditions	Units	Contents
Type of refrigerant	/	R410A / R134a
		R404A / R407C
Inlet air temperature	°C / °F	35/95
Inlet relative humidity	%	50
Sub cooling	K	4
Variable1: ($\Delta T=10$ K / 18 °F)		
Condensing temperature	°C / °F	45/113
Inlet refrigerant temperature	°C / °F	75/167
Variable1: ($\Delta T=15$ K / 27 °F)		
Condensing temperature	°C / °F	50/122
Inlet refrigerant temperature	°C / °F	80/176
Variable1: ($\Delta T=20$ K / 36 °F)		
Condensing temperature	°C / °F	55/131
Inlet refrigerant temperature	°C / °F	85/185
Variable1: ($\Delta T=25$ K / 45 °F)		
Condensing temperature	°C / °F	60/140
Inlet refrigerant temperature	°C / °F	90/194
Variable2: (air velocity)	[m/s] / [ft/min]	1.0/197
		1.5/295
		2.0/394
		2.5/492
		3.0/591

Remarks: ΔT = Condense temp. - Inlet air temp.

D1000-C Condenser coil

Micro-Channel Heat Exchanger

Drawing of Overall Dimensions

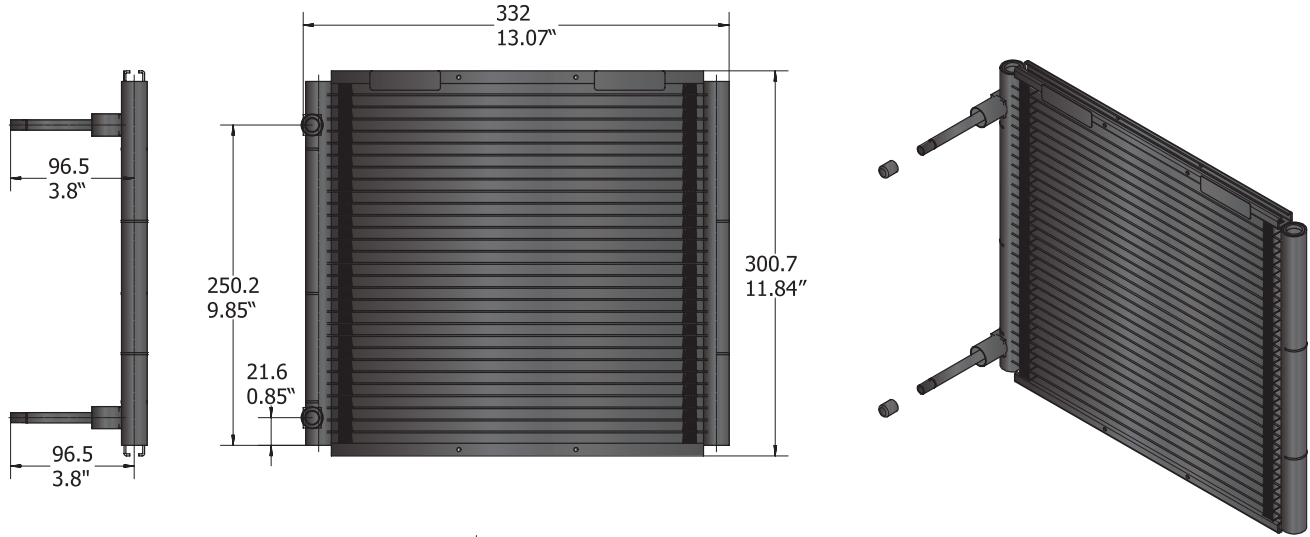

Technical Data

Model	Coil length	Coil height	Coil depth	Fin pitch	Fin height	Manifold diameter
D1000-C	332 [mm]	300.7 [mm]	16 [mm]	1.1 [mm]	8.1 [mm]	20 [mm]
	13.07 [in]	11.84 [in]	0.63 [in]	23 [FPI]	0.32 [in]	0.79 [in]
Model	Tubes height	Number of tubes	Internal volume	Coil weight	Inlet ID diameter	Outlet ID diameter
D1000-C	1.3 [mm]	29	0.17 [L]	0.823 [KG]	6.15 [mm]	6.15 [mm]
	0.05 [in]		10.37 [in³]	1.81 [LB]	0.24 [in]	0.24 [in]

Mounting Bars

Aluminum MCHEs expand and contract when exposed to big temperature changes. Installation supports/brackets must allow the MCHE to move in two dimensions.

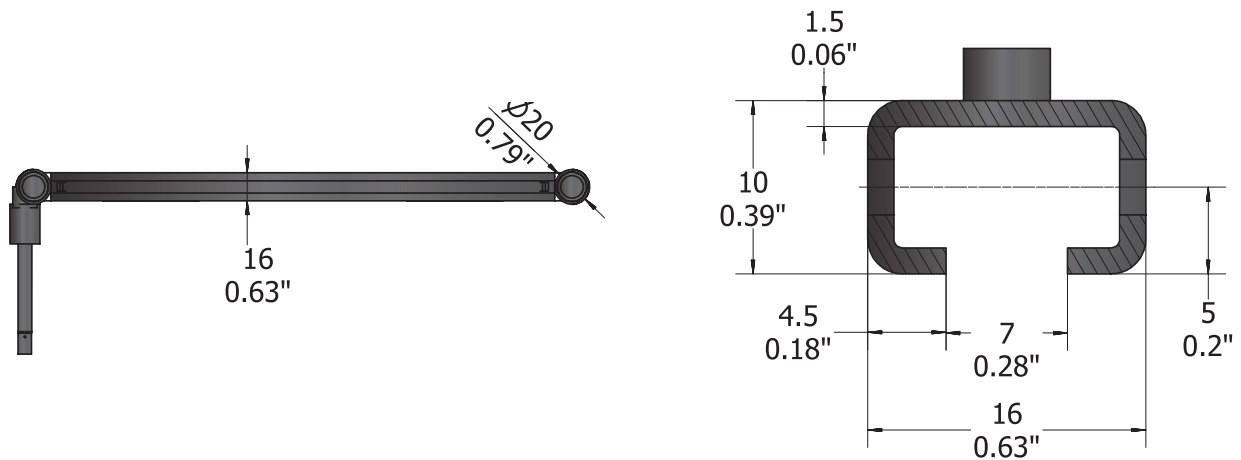

Performance Data

Air Velocity	Performance [KW/Btu/h×1000]							
[m/s]	R410A				R134a			
[ft/min]	Δ=10 K / 18 °F	Δ=15 K / 27 °F	Δ=20 K / 36 °F	Δ=25 K / 45 °F	Δ=10 K / 18 °F	Δ=15 K / 27 °F	Δ=20 K / 36 °F	Δ=25 K / 45 °F
1.0/197	0.8/2.73	1.22/4.16	1.69/5.77	2.14/7.3	0.76/2.59	1.17/3.99	1.58/5.39	2.02/6.89
1.5/295	1.1/3.75	1.75/5.97	2.38/8.12	3.00/10.24	1.04/3.55	1.61/5.49	2.23/7.61	2.82/9.62
2.0/394	1.36/4.64	2.2/7.51	2.98/10.17	3.77/12.86	1.28/4.37	1.99/6.79	2.77/9.45	3.5/11.94
2.5/492	1.67/5.7	2.59/8.84	3.52/12.01	4.47/15.25	1.49/5.08	2.39/8.15	3.25/11.09	4.08/13.92
3.0/591	1.9/6.48	2.96/10.1	4.02/13.72	5.11/17.44	1.67/5.7	2.71/9.25	3.67/12.52	4.61/15.73

Air Velocity	Performance [KW/Btu/h×1000]							
[m/s]	R404A				R407C			
[ft/min]	Δ=10 K / 18 °F	Δ=15 K / 27 °F	Δ=20 K / 36 °F	Δ=25 K / 45 °F	Δ=10 K / 18 °F	Δ=15 K / 27 °F	Δ=20 K / 36 °F	Δ=25 K / 45 °F
1.0/197	0.79/2.7	1.25/4.27	1.69/5.77	2.14/7.3	0.52/1.77	0.87/2.97	1.42/4.85	1.89/6.45
1.5/295	1.07/3.65	1.75/5.97	2.36/8.05	2.99/10.2	0.7/2.39	1.35/4.61	2.02/6.89	2.65/9.04
2.0/394	1.4/4.78	2.18/7.44	2.95/10.07	3.74/12.76	0.86/2.93	1.67/5.7	2.53/8.63	3.31/11.29
2.5/492	1.65/5.63	2.56/8.73	3.48/11.87	4.41/15.05	0.99/3.38	2.04/6.96	2.98/10.17	3.9/13.31
3.0/591	1.88/6.41	2.91/9.93	3.95/13.48	5.02/17.13	1.1/3.75	2.32/7.92	3.38/11.53	4.44/15.15

Air-side Pressure Drop Data

Air Velocity	Pressure drop	Flow rate
[m/s]	[Pa] / [inch H ₂ O]	[m ³ /h] / [cfm]
[ft/min]		
1.0/197	13.4/0.05	284.97/167.63
1.5/295	22.5/0.09	427.45/251.44
2.0/394	33.10/0.13	569.93/335.25
2.5/492	45.2/0.18	712.42/419.07
3.0/591	58.8/0.24	854.9/502.88

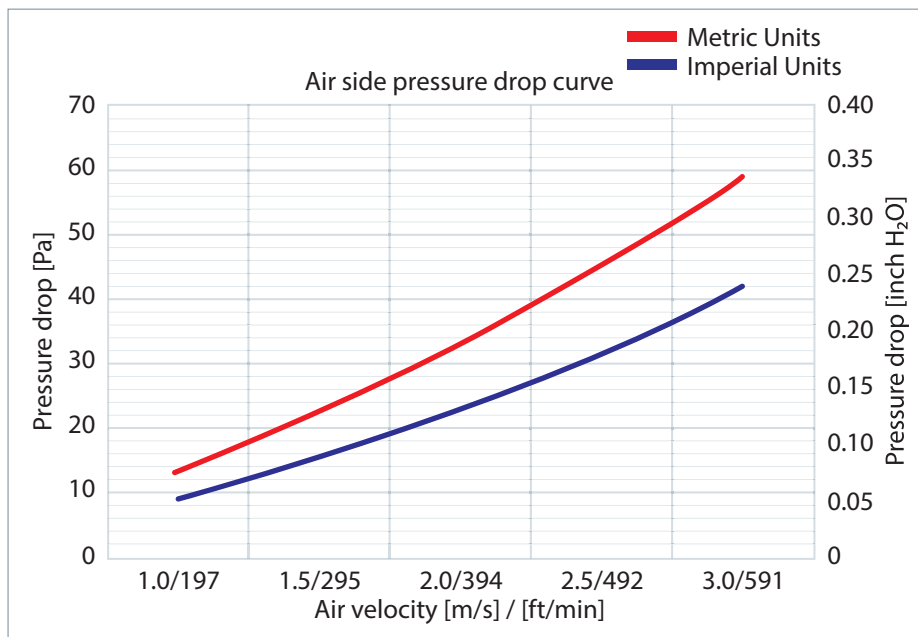

D1100-C Condenser coil

Micro-Channel Heat Exchanger

Drawing of Overall Dimensions

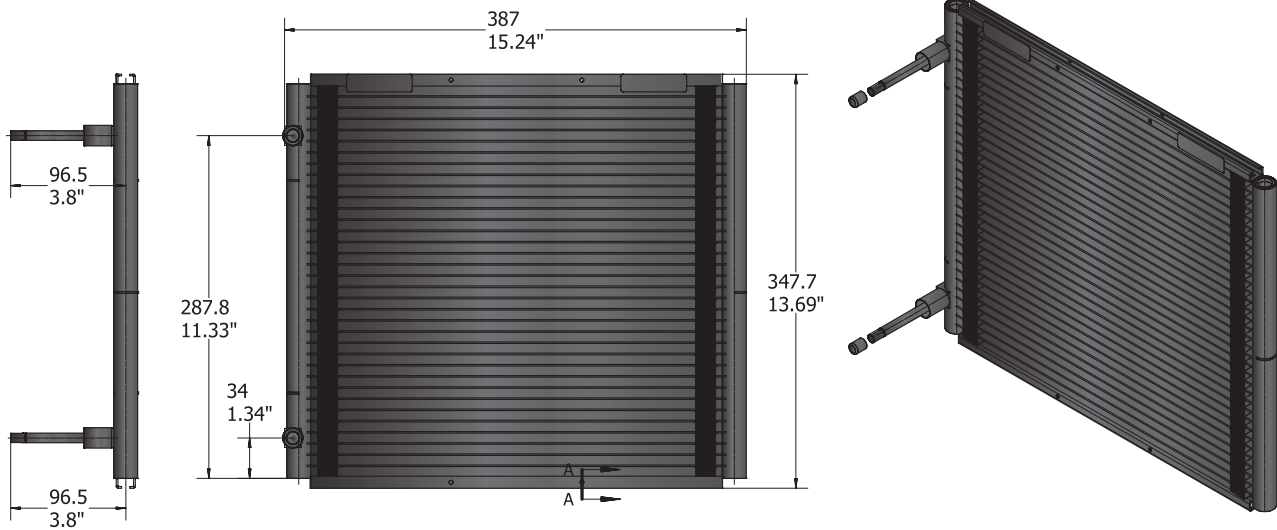

Technical Data

Model	Coil length	Coil height	Coil depth	Fin pitch	Fin height	Manifold diameter
D1100-C	387 [mm]	347.7 [mm]	16 [mm]	1.1 [mm]	8.1 [mm]	20 [mm]
	15.24 [in]	13.69 [in]	0.63 [in]	23 [FPI]	0.32 [in]	0.79 [in]
Model	Tubes height	Number of tubes	Internal volume	Coil weight	Inlet ID diameter	Outlet ID diameter
D1100-C	1.3 [mm]	29	0.22 [L]	1.071 [KG]	6.15 [mm]	6.15 [mm]
	0.05 [in]		13.42 [in³]	2.36 [LB]	0.24 [in]	0.24 [in]

Mounting Bars

Aluminum MCHEs expand and contract when exposed to big temperature changes. Installation supports/brackets must allow the MCHE to move in two dimensions.

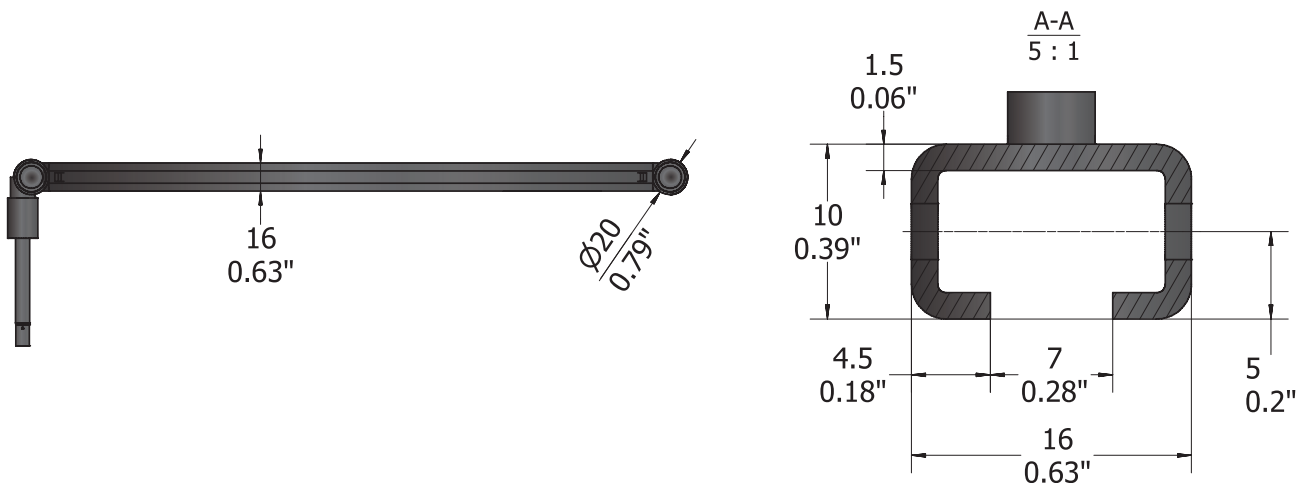

Performance Data

Air Velocity	Performance [KW/Btu/h×1000]							
[m/s]	R410A				R134a			
[ft/min]	Δ=10 K / 18 °F	Δ=15 K / 27 °F	Δ=20 K / 36 °F	Δ=25 K / 45 °F	Δ=10 K / 18 °F	Δ=15 K / 27 °F	Δ=20 K / 36 °F	Δ=25 K / 45 °F
1.0/197	1.1/3.75	1.69/5.77	2.29/7.81	2.96/10.1	1.05/3.58	1.63/5.56	2.2/7.51	2.77/9.45
1.5/295	1.51/5.15	2.34/7.98	3.28/11.19	4.16/14.19	1.44/4.91	2.24/7.64	3.03/10.34	3.83/13.07
2.0/394	1.87/6.38	2.98/10.17	4.11/14.02	5.24/17.88	1.77/6.04	2.76/9.42	3.75/12.8	4.88/16.65
2.5/492	2.19/7.47	3.57/12.18	4.88/16.65	6.21/21.19	2.06/7.03	3.22/10.99	4.39/14.98	5.74/19.58
3.0/591	2.48/8.46	4.07/13.89	5.58/19.04	7.11/24.26	2.32/7.92	3.64/12.42	5.14/17.54	6.49/22.14

Air Velocity	Performance [KW/Btu/h×1000]							
[m/s]	R404A				R407C			
[ft/min]	Δ=10 K / 18 °F	Δ=15 K / 27 °F	Δ=20 K / 36 °F	Δ=25 K / 45 °F	Δ=10 K / 18 °F	Δ=15 K / 27 °F	Δ=20 K / 36 °F	Δ=25 K / 45 °F
1.0/197	1.09/3.72	1.68/5.73	2.34/7.98	2.97/10.13	0.71/2.42	1.36/4.64	1.97/6.72	2.58/8.8
1.5/295	1.48/5.05	2.3/7.85	3.27/11.16	4.16/14.19	0.96/3.28	1.87/6.38	2.72/9.28	3.66/12.49
2.0/394	1.81/6.18	3/10.24	4.1/13.99	5.22/17.81	1.17/3.99	2.31/7.88	3.37/11.5	4.59/15.66
2.5/492	2.11/7.2	3.54/12.08	4.84/16.51	6.17/21.05	1.35/4.61	2.7/9.21	4.11/14.02	5.42/18.49
3.0/591	2.37/8.09	4.03/13.75	5.52/18.83	7.03/23.99	1.51/5.15	3.06/10.44	4.69/16	6.18/21.09

Air-side Pressure Drop Data

Air Velocity	Pressure drop	Flow rate
[m/s]	[Pa] / [inch H ₂ O]	[m ³ /h] / [cfm]
[ft/min]		
1.0/197	13.4/0.05	397.56/233.86
1.5/295	22.5/0.09	596.35/350.79
2.0/394	33.10/0.13	795.13/467.72
2.5/492	45.2/0.18	993.91/548.65
3.0/591	58.8/0.24	1192.7/701.59

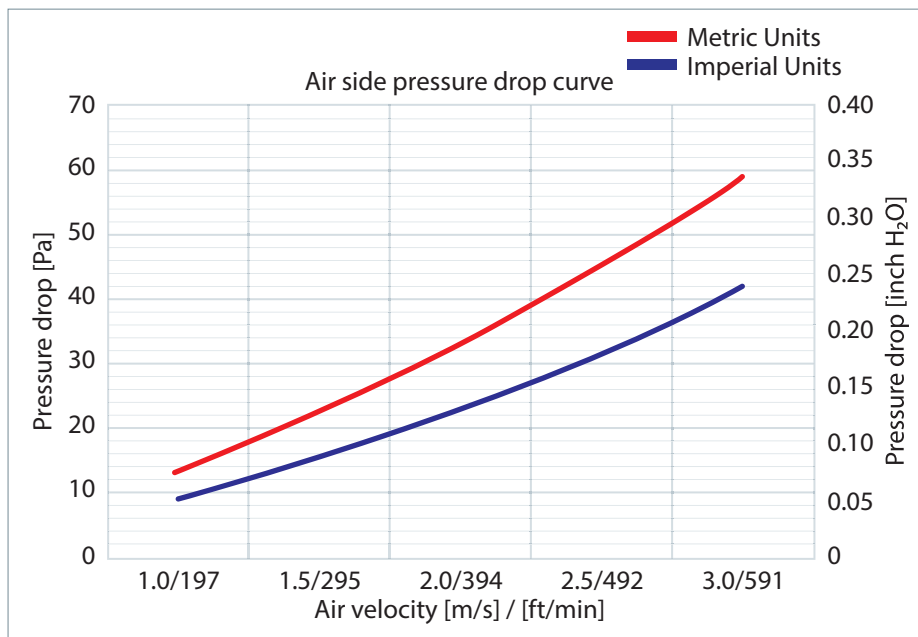

D1200-C Condenser coil

Micro-Channel Heat Exchanger

Drawing of Overall Dimensions

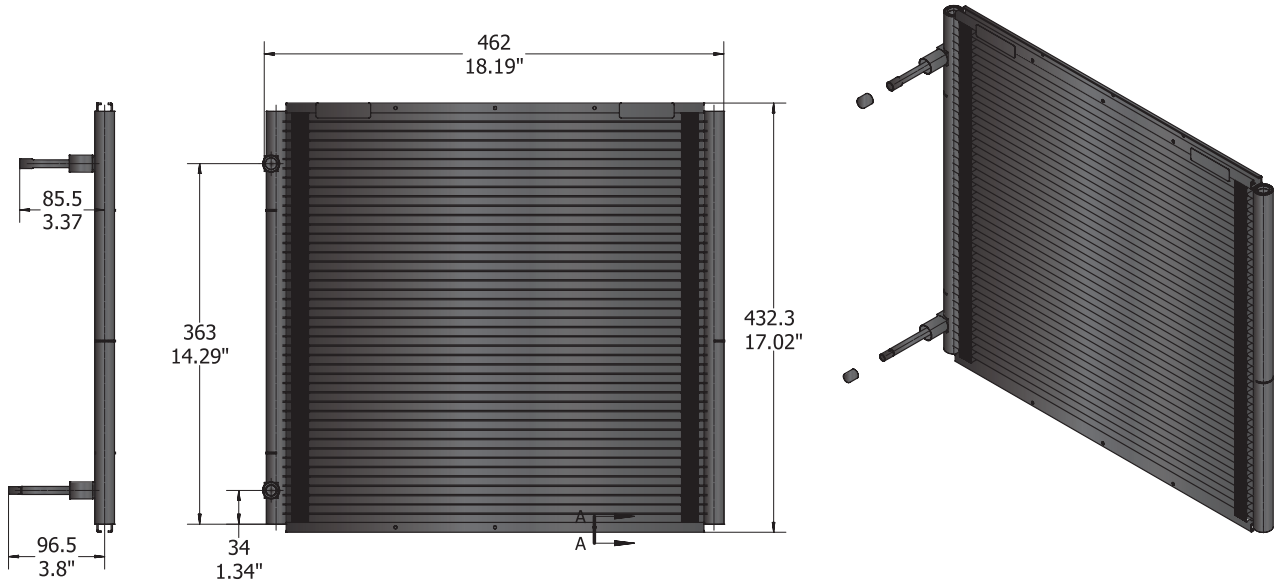

Technical Data

Model	Coil length	Coil height	Coil depth	Fin pitch	Fin height	Manifold diameter
D1200-C	462 [mm]	432.3 [mm]	16 [mm]	1.1 [mm]	8.1 [mm]	20 [mm]
	18.19 [in]	17.02 [in]	0.63 [in]	23 [FPI]	0.32 [in]	0.79 [in]
Model	Tubes height	Number of tubes	Internal volume	Coil weight	Inlet ID diameter	Outlet ID diameter
D1200-C	1.3 [mm]	43	0.3 [L]	1.534 [KG]	8.2 [mm]	6.15 [mm]
	0.05 [in]		18.3 [in ³]	3.37 [LB]	0.32 [in]	0.24 [in]

Mounting Bars

Aluminum MCHEs expand and contract when exposed to big temperature changes. Installation supports/brackets must allow the MCHEx to move in two dimensions.

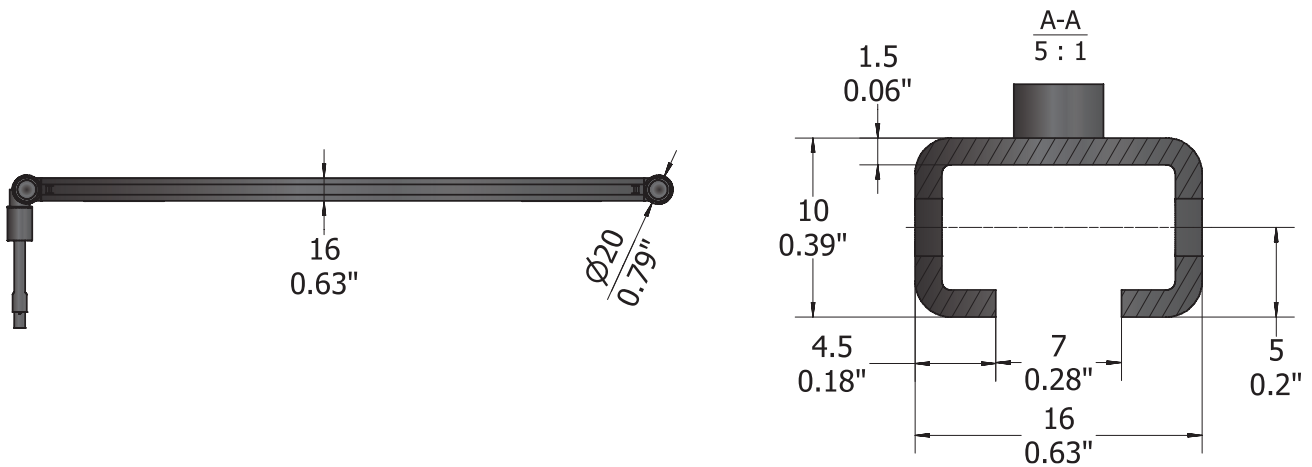

Performance Data

Air Velocity	Performance [KW/Btu/h×1000]							
[m/s]	R410A				R134a			
[ft/min]	Δ=10 K / 18 °F	Δ=15 K / 27 °F	Δ=20 K / 36 °F	Δ=25 K / 45 °F	Δ=10 K / 18 °F	Δ=15 K / 27 °F	Δ=20 K / 36 °F	Δ=25 K / 45 °F
1.0/197	1.72/5.87	2.64/9.01	3.63/12.39	4.59/15.66	1.64/5.6	2.53/8.63	3.4/11.6	4.34/14.81
1.5/295	2.37/8.09	3.76/12.83	5.09/17.37	6.45/22.01	3.46/11.81	3.46/11.81	4.77/16.28	6.03/20.57
2.0/394	2.93/10	4.71/16.07	6.39/21.8	8.1/27.64	2.75/9.38	4.26/14.54	5.94/20.27	7.49/25.56
2.5/492	3.58/12.21	5.58/19.04	7.57/25.83	9.6/32.76	3.19/10.88	4.96/16.92	6.94/23.68	8.73/29.79
3.0/591	4.08/13.92	6.35/21.67	8.64/29.48	10.97/37.43	3.58/12.21	5.77/19.69	7.84/26.75	9.85/33.61

Air Velocity	Performance [KW/Btu/h×1000]							
[m/s]	R404A				R407C			
[ft/min]	Δ=10 K / 18 °F	Δ=15 K / 27 °F	Δ=20 K / 36 °F	Δ=25 K / 45 °F	Δ=10 K / 18 °F	Δ=15 K / 27 °F	Δ=20 K / 36 °F	Δ=25 K / 45 °F
1.0/197	1.69/5.77	2.69/9.18	3.64/12.42	4.6/15.7	1.11/3.79	2.12/7.23	3.06/10.44	4.06/13.85
1.5/295	2.3/7.85	3.75/12.8	5.08/17.33	6.43/21.94	1.51/5.15	2.92/9.96	4.33/14.77	5.68/19.38
2.0/394	2.99/10.2	4.68/15.97	6.34/21.63	8.03/27.4	1.84/6.28	3.59/12.25	5.42/18.49	7.09/24.19
2.5/492	3.53/12.04	5.5/18.77	7.47/25.49	9.47/32.31	2.11/7.2	4.2/14.33	6.39/21.8	8.36/28.52
3.0/591	4.01/13.68	6.24/21.29	8.49/28.97	10.76/36.71	2.36/8.05	4.97/16.96	7.25/24.74	9.51/32.45

Air-side Pressure Drop Data

Air Velocity	Pressure drop	Flow rate
[m/s]	[Pa] / [inch H ₂ O]	[m ³ /h] / [cfm]
[ft/min]		
1.0/197	13.4/0.05	611.52/359.72
1.5/295	22.5/0.09	917.29/539.78
2.0/394	33.10/0.13	1223.05/719.44
2.5/492	45.2/0.18	1528.81/899.30
3.0/591	58.8/0.24	1834.57/1079.16

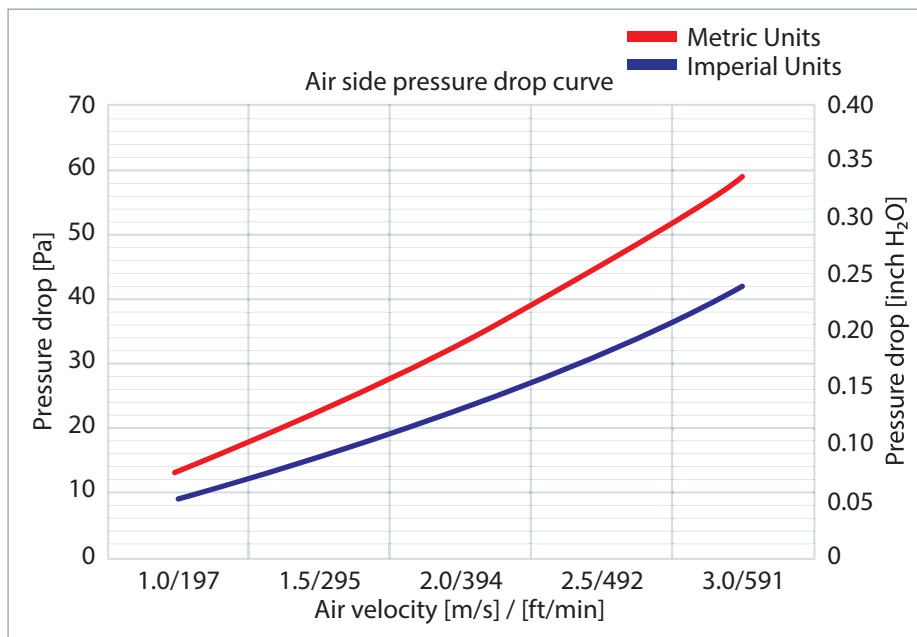

D1300-C Condenser coil

Micro-Channel Heat Exchanger

Drawing of Overall Dimensions

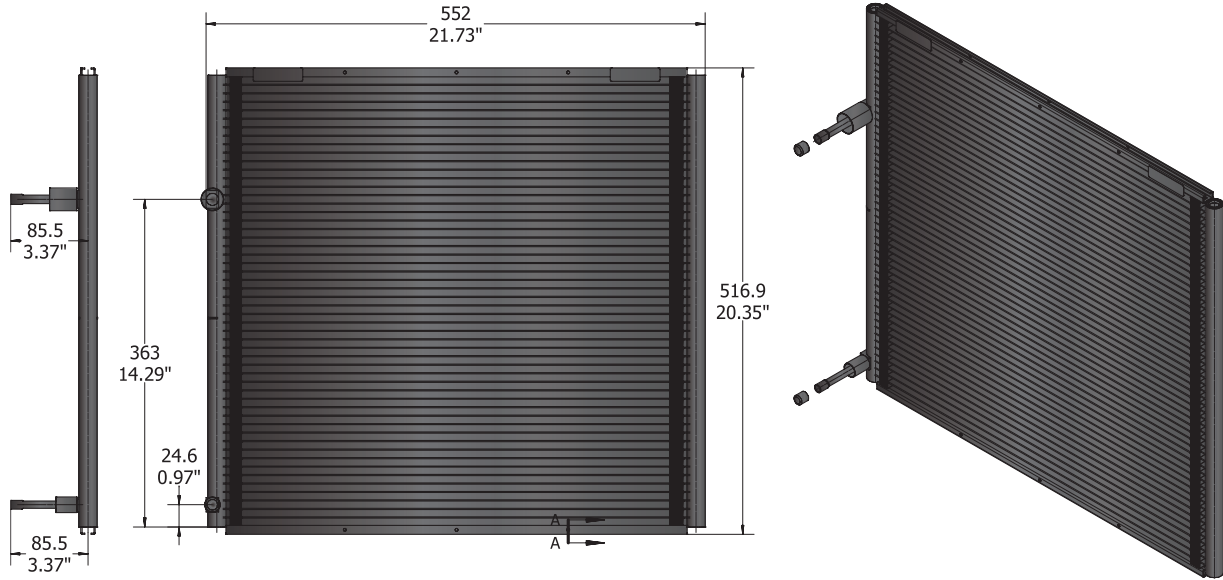

Technical Data

Model	Coil length	Coil height	Coil depth	Fin pitch	Fin height	Manifold diameter
D1300-C	552 [mm]	516.9 [mm]	16 [mm]	1.1 [mm]	8.1 [mm]	20 [mm]
	21.73 [in]	20.35 [in]	0.63 [in]	23 [FPI]	0.32 [in]	0.79 [in]
Model	Tubes height	Number of tubes	Internal volume	Coil weight	Inlet ID diameter	Outlet ID diameter
D1300-C	1.3 [mm]	52	0.4 [L]	2.22 [KG]	9.7 [mm]	8.20 [mm]
	0.05 [in]		24.4 [in ³]	4.88 [LB]	0.38 [in]	0.32 [in]

Mounting Bars

Aluminum MCHEs expand and contract when exposed to big temperature changes. Installation supports/brackets must allow the MCHE to move in two dimensions.

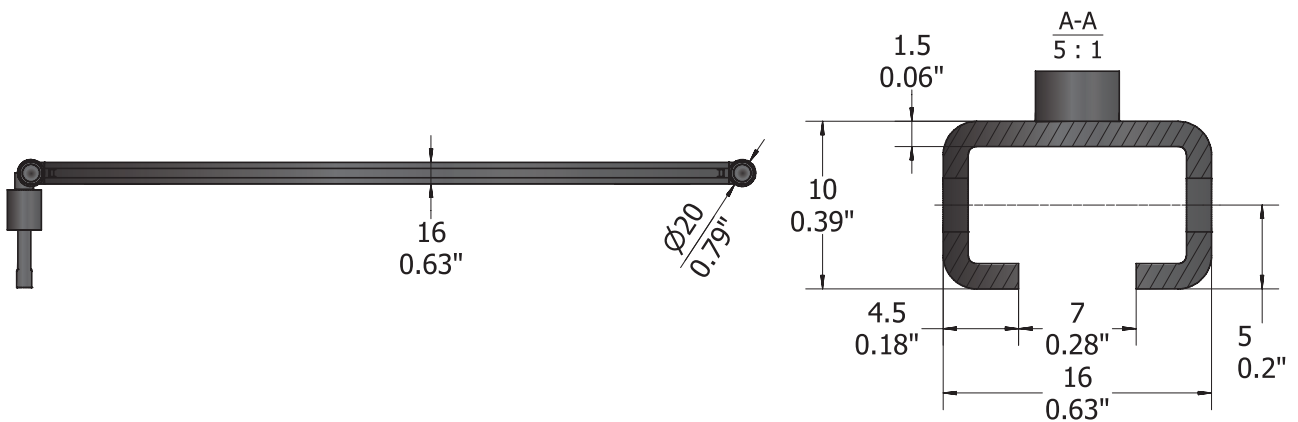

Performance Data

Air Velocity	Performance [KW/Btu/h×1000]							
[m/s]	R410A				R134a			
[ft/min]	Δ=10 K / 18 °F	Δ=15 K / 27 °F	Δ=20 K / 36 °F	Δ=25 K / 45 °F	Δ=10 K / 18 °F	Δ=15 K / 27 °F	Δ=20 K / 36 °F	Δ=25 K / 45 °F
1.0/197	2.08/7.1	3.73/12.73	5.08/17.33	6.42/21.91	2.3/7.85	3.61/12.32	4.91/16.75	6.2/21.15
1.5/295	3.27/11.16	5.15/17.57	7.02/23.95	9.23/31.49	3.15/10.75	4.98/16.99	6.78/23.13	8.57/29.24
2.0/394	4.05/13.82	6.39/21.8	9.04/30.84	11.61/39.61	3.89/13.27	6.16/21.02	8.41/28.69	10.65/36.34
2.5/492	4.75/16.21	7.49/25.56	10.74/36.64	13.79/47.05	4.54/15.49	7.22/24.63	9.85/33.61	12.49/42.62
3.0/591	5.37/18.32	8.49/28.97	12.49/42.62	15.79/53.88	5.13/17.5	8.16/27.84	11.18/38.15	14.41/49.17

Air Velocity	Performance [KW/Btu/h×1000]							
[m/s]	R404A				R407C			
[ft/min]	Δ=10 K / 18 °F	Δ=15 K / 27 °F	Δ=20 K / 36 °F	Δ=25 K / 45 °F	Δ=10 K / 18 °F	Δ=15 K / 27 °F	Δ=20 K / 36 °F	Δ=25 K / 45 °F
1.0/197	2.37/8.09	3.71/12.66	5.04/17.2	6.55/22.35	1.44/4.91	2.98/10.17	4.37/14.91	5.74/19.58
1.5/295	3.23/11.02	5.08/17.33	6.91/23.58	9.27/31.63	1.87/6.38	4.1/13.99	6.03/20.57	7.95/27.13
2.0/394	3.96/13.51	6.26/21.36	9.07/30.95	11.65/39.75	2.51/8.56	5.08/17.33	7.49/25.56	9.88/33.71
2.5/492	4.61/15.73	7.29/24.87	10.75/36.68	13.79/47.05	2.93/10	5.93/20.23	8.78/29.96	11.67/39.82
3.0/591	5.18/17.67	8.31/28.35	12.28/41.9	15.77/53.81	3.27/11.16	6.7/22.86	9.94/33.92	13.73/46.85

Air-side Pressure Drop Data

Air Velocity	Pressure drop	Flow rate
[m/s]	[Pa] / [inch H ₂ O]	[m ³ /h] / [cfm]
[ft/min]		
1.0/197	13.4/0.05	898/528.24
1.5/295	22.5/0.09	1347/792.35
2.0/394	33.10/0.13	1796/1056.47
2.5/492	45.2/0.18	2245/1320.59
3.0/591	58.8/0.24	2694/1584.71

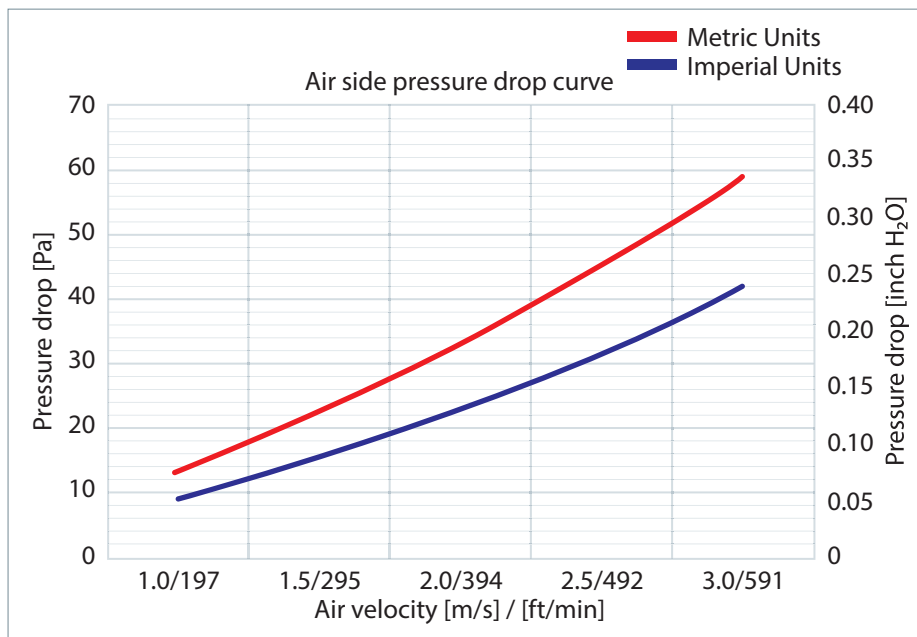

D1400-C Condenser coil

Micro-Channel Heat Exchanger

Drawing of Overall Dimensions

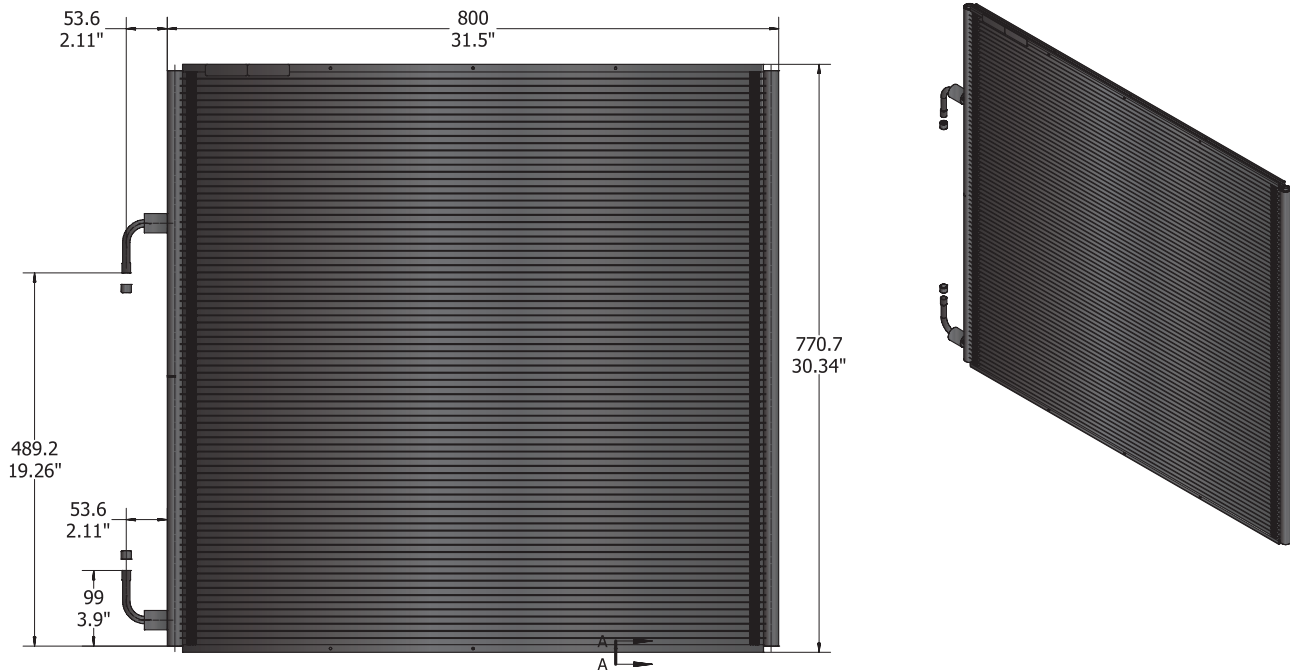

Technical Data

Model	Coil length	Coil height	Coil depth	Fin pitch	Fin height	Manifold diameter
D1400-C	800 [mm]	770.7 [mm]	16 [mm]	1.1 [mm]	8.1 [mm]	20 [mm]
	31.5 [in]	30.34 [in]	0.63 [in]	23 [FPI]	0.32 [in]	0.79 [in]
Model	Tubes height	Number of tubes	Internal volume	Coil weight	Inlet ID diameter	Outlet ID diameter
D1400-C	1.3 [mm]	79	0.74 [L]	4.51 [KG]	9.7 [mm]	9.7 [mm]
	0.05 [in]		45.14 [in³]	9.92 [LB]	0.38 [in]	0.38 [in]

Mounting Bars

Aluminum MCHEs expand and contract when exposed to big temperature changes. Installation supports/brackets must allow the MCHE to move in two dimensions.

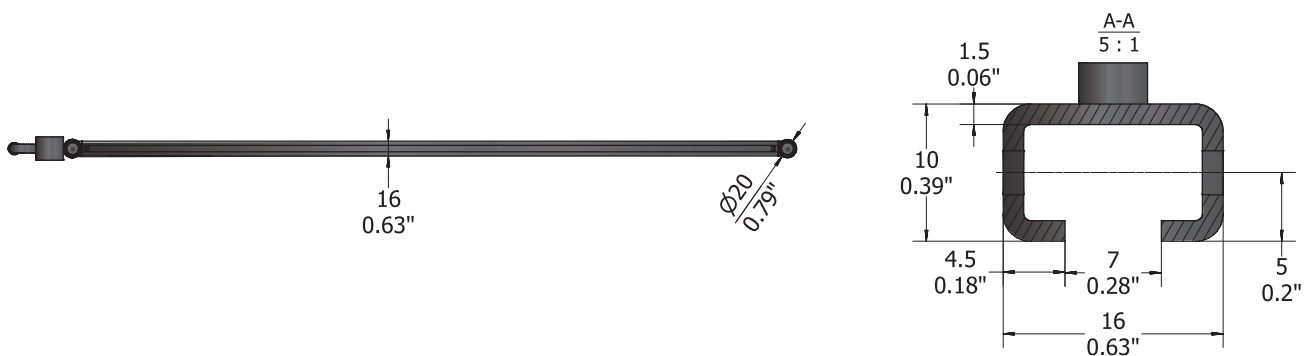

Performance Data

Air Velocity	Performance [KW/Btu/h×1000]							
[m/s]	R410A				R134a			
[ft/min]	Δ=10 K / 18 °F	Δ=15 K / 27 °F	Δ=20 K / 36 °F	Δ=25 K / 45 °F	Δ=10 K / 18 °F	Δ=15 K / 27 °F	Δ=20 K / 36 °F	Δ=25 K / 45 °F
1.0/197	5.64/19.24	8.69/29.65	11.73/40.02	15.15/51.69	5.43/18.53	8.36/28.52	11.27/38.45	14.17/48.35
1.5/295	7.79/26.58	12.02/41.01	16.76/57.19	21.29/72.64	7.43/25.35	11.5/39.24	15.55/53.06	19.57/66.77
2.0/394	9.66/32.96	14.93/50.94	21.05/71.82	26.75/91.27	9.15/31.22	14.2/48.45	19.23/65.61	24.77/84.52
2.5/492	11.32/38.62	18.26/62.3	24.93/85.06	31.72/108.23	10.65/36.34	16.56/56.5	22.49/76.74	29.08/99.22
3.0/591	12.82/43.74	20.86/71.17	28.5/97.24	36.26/123.72	11.98/40.88	18.69/63.77	26.17/89.29	32.96/112.46

Air Velocity	Performance [KW/Btu/h×1000]							
[m/s]	R404A				R407C			
[ft/min]	Δ=10 K / 18 °F	Δ=15 K / 27 °F	Δ=20 K / 36 °F	Δ=25 K / 45 °F	Δ=10 K / 18 °F	Δ=15 K / 27 °F	Δ=20 K / 36 °F	Δ=25 K / 45 °F
1.0/197	5.58/19.04	8.62/29.41	11.99/40.91	15.2/51.86	3.68/12.56	7/23.88	10.13/34.56	13.24/45.17
1.5/295	7.64/26.07	11.82/40.33	16.76/57.19	21.26/72.54	5/17.06	9.66/32.96	14.01/47.8	18.6/63.46
2.0/394	9.39/32.04	15.35/52.37	20.95/71.48	26.63/90.86	6.12/20.88	11.94/40.74	17.39/59.33	23.44/79.98
2.5/492	10.91/37.22	18.11/61.79	24.72/84.34	31.42/107.21	7.1/24.23	13.95/47.6	20.87/71.21	27.68/94.44
3.0/591	12.27/41.87	20.6/70.29	28.15/96.05	35.78/122.08	7.92/27.02	15.79/53.88	23.91/81.58	31.53/107.58

Air-side Pressure Drop Data

Air Velocity	Pressure drop	Flow rate
[m/s]	[Pa] / [inch H ₂ O]	[m ³ /h] / [cfm]
[ft/min]		
1.0/197	13.4/0.05	2026.89/1192.29
1.5/295	22.5/0.09	3040.33/1788.43
2.0/394	33.10/0.13	4053.78/2384.58
2.5/492	45.2/0.18	5067.2/2980.72
3.0/591	58.8/0.24	6080.67/3576.86

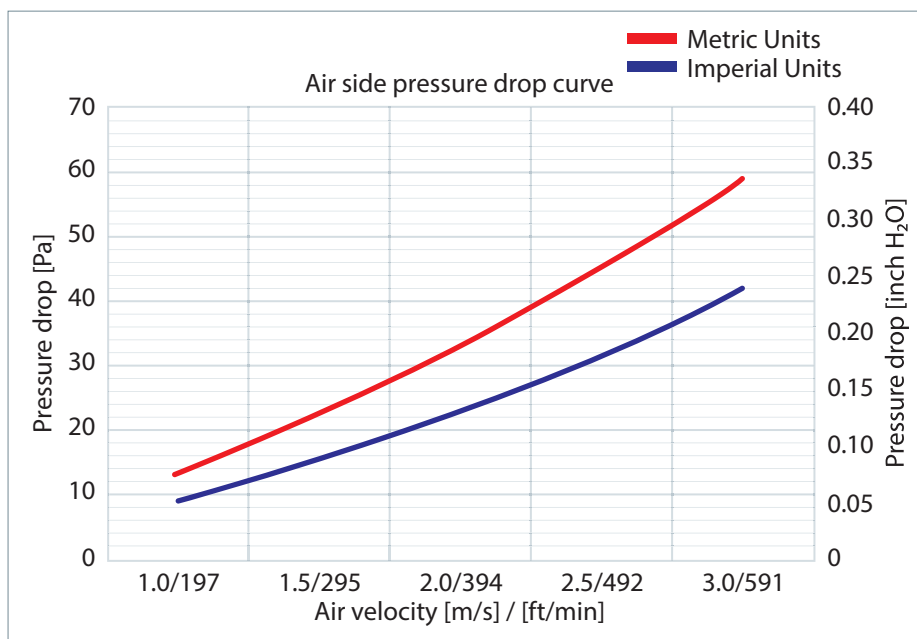

D1500-C Condenser coil

Micro-Channel Heat Exchanger

Drawing of Overall Dimensions

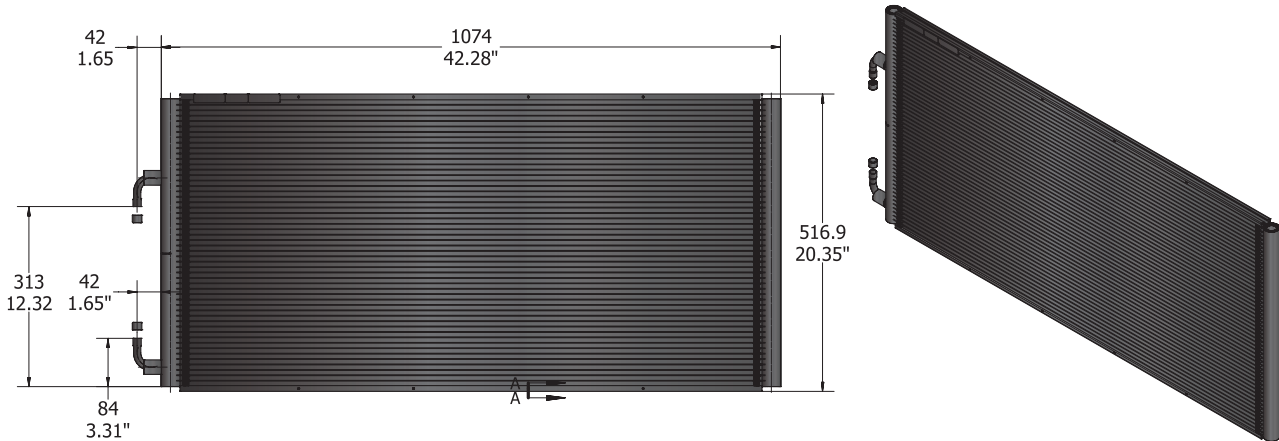

Technical Data

Model	Coil length	Coil height	Coil depth	Fin pitch	Fin height	Manifold diameter
D1500-C	1074 [mm]	516.9 [mm]	25.4 [mm]	1.1 [mm]	8.1 [mm]	32 [mm]
	42.28 [in]	20.35 [in]	1 [in]	23 [FPI]	0.32 [in]	1.26 [in]
Model	Tubes height	Number of tubes	Internal volume	Coil weight	Inlet ID diameter	Outlet ID diameter
D1500-C	1.3 [mm]	52	1.15 [L]	6.515 [KG]	12.9 [mm]	12.9 [mm]
	0.05 [in]		70.76 [in ³]	14.33 [LB]	0.51 [in]	0.51 [in]

Mounting Bars

Aluminum MCHEs expand and contract when exposed to big temperature changes. Installation supports/brackets must allow the MCHE to move in two dimensions.

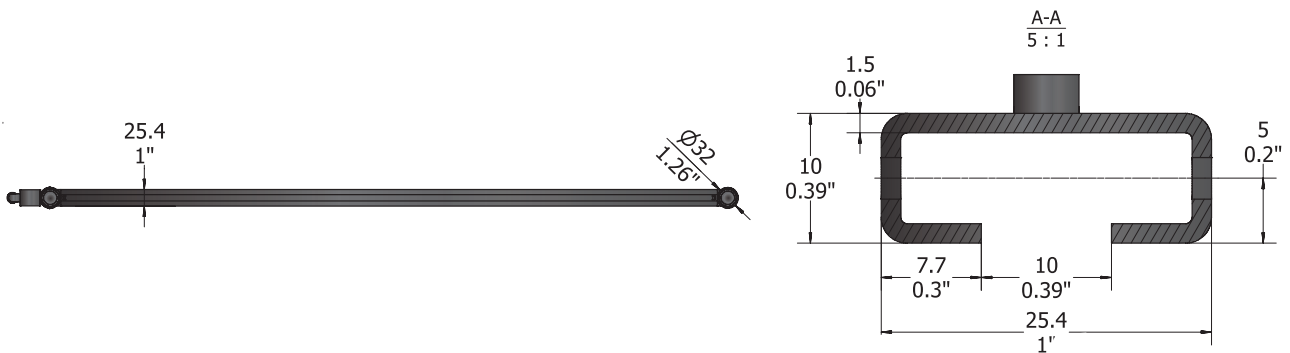

Performance Data

Air Velocity	Performance [KW/Btu/h×1000]							
[m/s]	R410A				R134a			
[ft/min]	Δ=10 K / 18 °F	Δ=15 K / 27 °F	Δ=20 K / 36 °F	Δ=25 K / 45 °F	Δ=10 K / 18 °F	Δ=15 K / 27 °F	Δ=20 K / 36 °F	Δ=25 K / 45 °F
1.0/197	5.54/18.9	8.24/28.11	11.33/38.66	14.41/49.17	5.31/18.12	8.1/27.64	10.85/37.02	13.62/46.47
1.5/295	7.9/26.95	12.05/41.11	16.47/56.2	20.79/70.94	7.48/25.52	11.46/39.1	15.41/52.58	19.36/66.06
2.0/394	10.03/34.22	15.33/52.31	21.12/72.06	26.68/91.03	9.4/32.07	14.45/49.3	19.49/66.5	24.86/84.82
2.5/492	11.97/40.84	18.78/64.08	25.42/86.73	32.13/109.63	11.11/37.91	17.14/58.48	23.12/78.89	29.46/100.52
3.0/591	13.75/46.92	21.73/74.14	29.41/100.35	37.22/126.99	12.67/43.23	19.58/66.81	26.92/91.85	33.71/115.02

Air Velocity	Performance [KW/Btu/h×1000]							
[m/s]	R404A				R407C			
[ft/min]	Δ=10 K / 18 °F	Δ=15 K / 27 °F	Δ=20 K / 36 °F	Δ=25 K / 45 °F	Δ=10 K / 18 °F	Δ=15 K / 27 °F	Δ=20 K / 36 °F	Δ=25 K / 45 °F
1.0/197	5.52/18.83	8.41/28.69	11.29/38.52	14.45/49.3	3.7/12.62	2.98/10.17	9.81/33.47	12.74/43.47
1.5/295	7.8/26.61	11.92/40.67	16.47/56.2	20.78/70.9	5.19/17.71	4.1/13.99	13.99/47.73	18.19/62.06
2.0/394	9.82/33.51	15.57/53.12	21.01/71.69	26.53/90.52	6.51/22.21	5.08/17.33	17.74/60.53	23.5/80.18
2.5/492	11.64/39.72	18.6/63.46	25.17/85.88	31.79/108.47	7.69/26.24	5.93/20.23	21.2/72.33	28.18/96.15
3.0/591	13.28/45.31	21.41/73.05	28.97/98.85	36.63/124.98	8.75/29.86	16.84/57.46	24.93/85.06	32.48/110.82

Air-side Pressure Drop Data

Air Velocity	Pressure drop	Flow rate
[m/s]	[Pa] / [inch H ₂ O]	[m ³ /h] / [cfm]
[ft/min]		
1.0/197	18.3/0.07	1788.84/1052.26
1.5/295	30.6/0.12	2683.26/1578.39
2.0/394	45.1/0.18	3577.68/2104.52
2.5/492	61.8/0.25	4472.1/2630.65
3.0/591	80.6/0.32	5366.52/3156.78

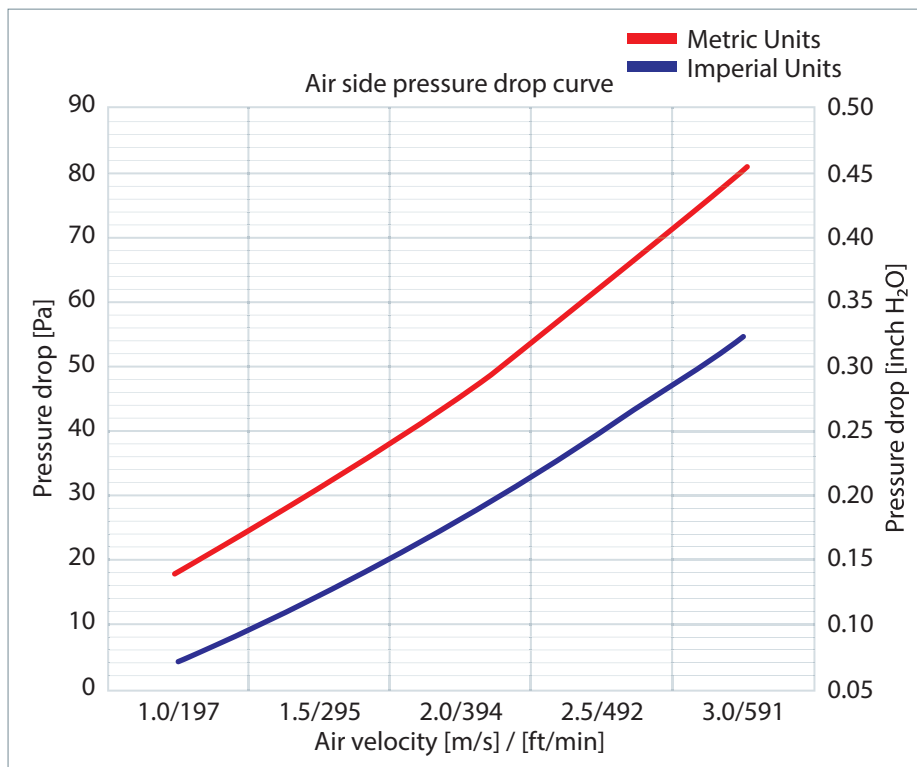

D1600-C Condenser coil

Micro-Channel Heat Exchanger

Drawing of Overall Dimensions

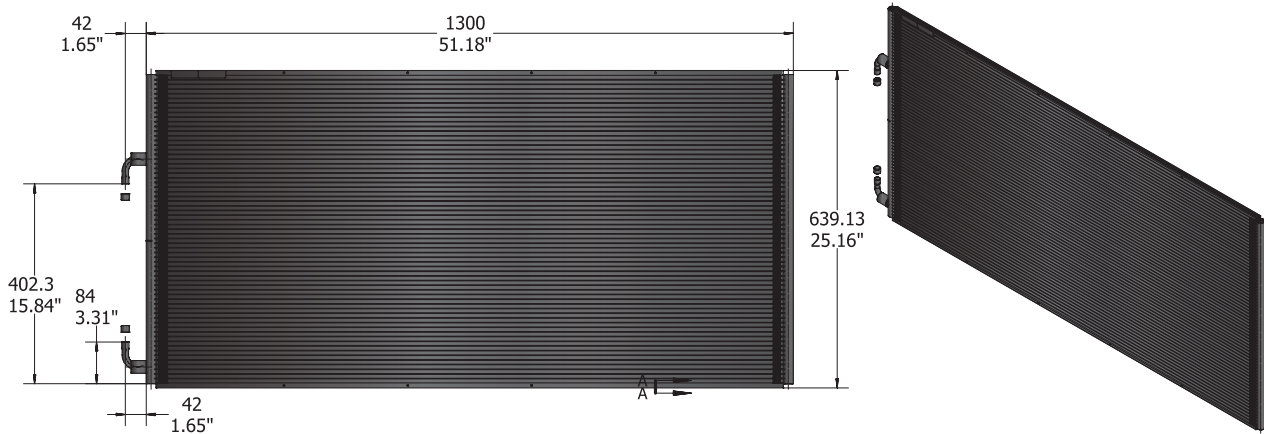

Technical Data

Model	Coil length	Coil height	Coil depth	Fin pitch	Fin height	Manifold diameter
D1600-C	1300 [mm]	639.1 [mm]	16 [mm]	1.1 [mm]	8.1 [mm]	20 [mm]
	51.18 [in]	25.16 [in]	0.63 [in]	23 [FPI]	0.32 [in]	0.79 [in]
Model	Tubes height	Number of tubes	Internal volume	Coil weight	Inlet ID diameter	Outlet ID diameter
D1600-C	1.3 [mm]	65	0.84 [L]	6.012 [KG]	12.9 [mm]	12.9 [mm]
	0.05 [in]		51.24 [in ³]	13.23 [LB]	0.51 [in]	0.51 [in]

Mounting Bars

Aluminum MCHEs expand and contract when exposed to big temperature changes. Installation supports/brackets must allow the MCHE to move in two dimensions.

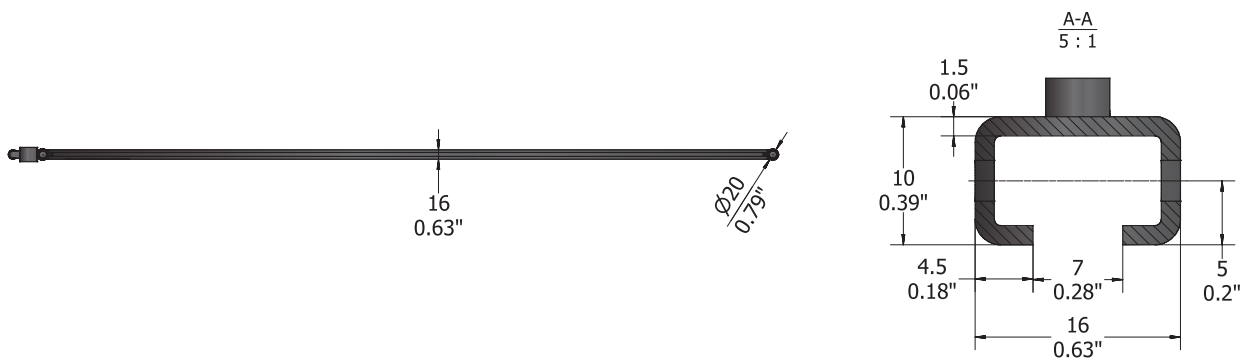

Performance Data

Air Velocity	Performance [KW/Btu/h×1000]							
[m/s]	R410A				R134a			
[ft/min]	Δ=10 K / 18 °F	Δ=15 K / 27 °F	Δ=20 K / 36 °F	Δ=25 K / 45 °F	Δ=10 K / 18 °F	Δ=15 K / 27 °F	Δ=20 K / 36 °F	Δ=25 K / 45 °F
1.0/197	7.99/27.26	12.15/41.46	16.6/56.64	20.93/71.41	7.42/25.32	11.33/38.66	15.26/52.07	19.4/66.19
1.5/295	11.02/37.6	17.16/58.55	23.13/78.92	29.19/99.6	10/34.12	15.36/52.41	20.98/71.58	26.13/89.16
2.0/394	13.64/46.54	21.4/73.02	28.84/98.4	36.4/124.2	12.12/41.35	18.68/63.74	25.15/85.81	31.71/108.19
2.5/492	16.41/55.99	25.12/85.71	33.89/115.63	42.78/145.97	13.91/47.46	21.48/73.29	28.81/98.3	36.32/123.92
3.0/591	18.6/63.46	28.48/97.17	38.39/130.99	48.49/165.45	15.44/52.68	24.27/82.81	31.89/108.81	40.24/137.3

Air Velocity	Performance [KW/Btu/h×1000]							
[m/s]	R404A				R407C			
[ft/min]	Δ=10 K / 18 °F	Δ=15 K / 27 °F	Δ=20 K / 36 °F	Δ=25 K / 45 °F	Δ=10 K / 18 °F	Δ=15 K / 27 °F	Δ=20 K / 36 °F	Δ=25 K / 45 °F
1.0/197	7.83/26.72	12.23/41.73	16.46/56.16	20.74/70.76	5.22/17.81	9.77/33.34	14.03/47.87	18.43/62.88
1.5/295	10.65/36.34	16.83/57.42	22.68/77.38	28.59/97.55	7.02/23.95	13.39/45.69	19.51/66.57	25.43/86.77
2.0/394	13.62/46.47	20.74/70.76	27.92/95.26	35.26/120.31	8.51/29.04	16.45/56.13	24.08/82.16	31.39/107.1
2.5/492	15.73/53.67	24.09/82.2	32.46/110.75	40.98/139.82	9.75/33.27	19.53/66.64	28.01/95.57	36.55/124.71
3.0/591	17.67/60.29	27.03/92.23	36.41/124.23	45.97/156.85	10.81/36.88	21.85/74.55	31.46/107.34	41.05/140.06

Air-side Pressure Drop Data

Air Velocity	Pressure drop	Flow rate
[m/s]	[Pa] / [inch H ₂ O]	[m ³ /h] / [cfm]
[ft/min]		
1.0/197	13.4/0.05	2785.95/1638.79
1.5/295	22.5/0.09	4178.93/2458.19
2.0/394	33.10/0.13	5571.9/3277.59
2.5/492	45.2/0.18	6964.88/4096.99
3.0/591	58.8/0.24	8357.85/4916.38

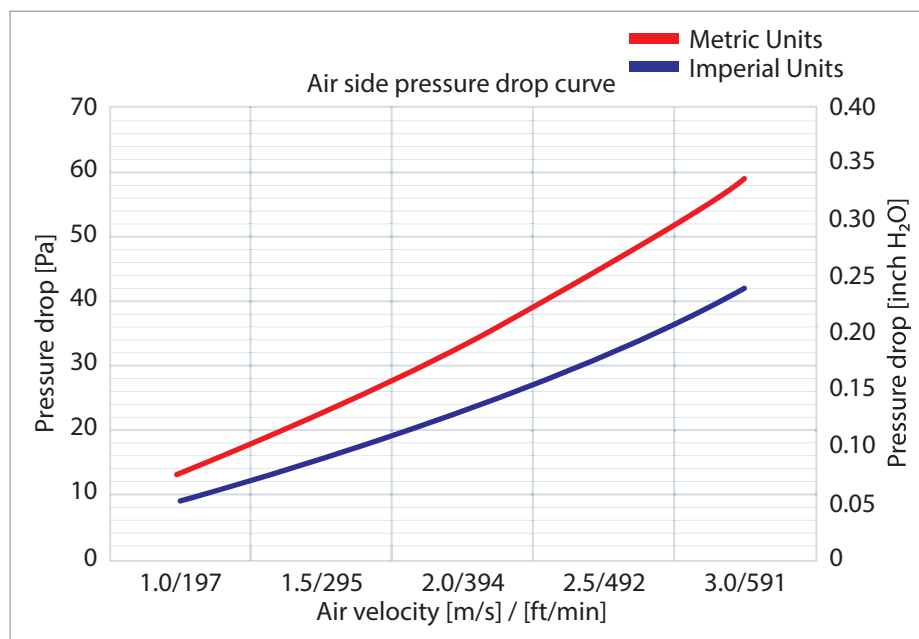

D1700-C Condenser coil

Micro-Channel Heat Exchanger

Drawing of Overall Dimensions

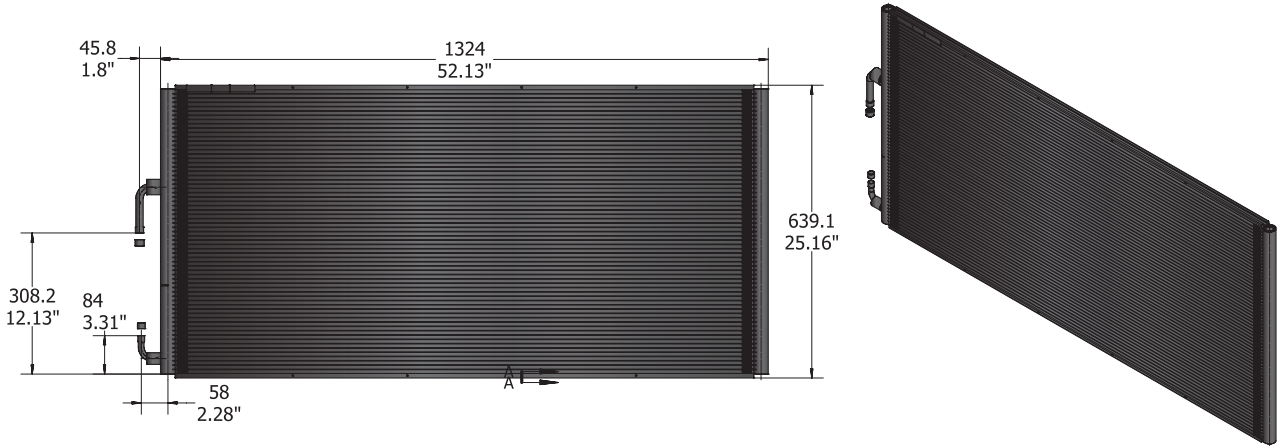

Technical Data

Model	Coil length	Coil height	Coil depth	Fin pitch	Fin height	Manifold diameter
D1700-C	1324 [mm]	639.1 [mm]	25.4 [mm]	1.1 [mm]	8.1 [mm]	32 [mm]
	52.13 [in]	25.16 [in]	1 [in]	23 [FPI]	0.32 [in]	1.26 [in]
Model	Tubes height	Number of tubes	Internal volume	Coil weight	Inlet ID diameter	Outlet ID diameter
D1700-C	1.3 [mm]	65	1.63 [L]	9.777 [KG]	16.1 [mm]	12.9 [mm]
	0.05 [in]		99.43 [in ³]	21.51 [LB]	0.63 [in]	0.51 [in]

Mounting Bars

Aluminum MCHEs expand and contract when exposed to big temperature changes. Installation supports/brackets must allow the MCHE to move in two dimensions.

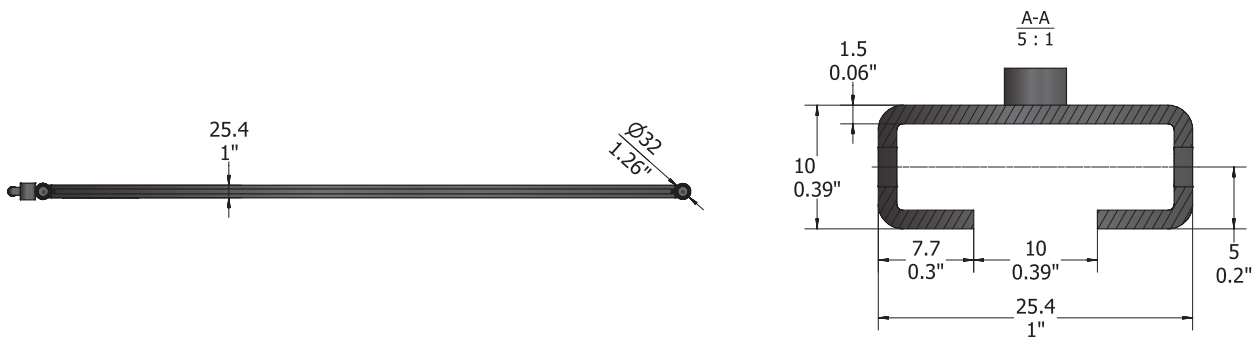

Performance Data

Air Velocity	Performance [KW/Btu/h×1000]							
[m/s]	R410A				R134a			
[ft/min]	Δ=10 K / 18 °F	Δ=15 K / 27 °F	Δ=20 K / 36 °F	Δ=25 K / 45 °F	Δ=10 K / 18 °F	Δ=15 K / 27 °F	Δ=20 K / 36 °F	Δ=25 K / 45 °F
1.0/197	8.66/29.55	13.17/44.94	17.88/61.01	22.5/76.77	8.31/28.35	12.64/43.13	16.94/57.8	21.37/72.91
1.5/295	12.36/42.17	19.13/65.27	25.77/87.93	32.45/110.72	11.72/39.99	17.91/61.11	24.27/82.81	30.53/104.17
2.0/394	16.01/54.63	24.53/83.7	32.98/112.53	41.6/141.94	14.74/50.29	22.6/77.11	30.76/104.95	38.75/132.22
2.5/492	19.25/65.68	29.5/100.65	39.7/135.46	50.06/170.8	17.44/59.51	27.16/92.67	36.62/124.95	45.81/156.3
3.0/591	22.26/75.95	34.03/116.11	45.89/156.58	57.95/197.73	19.88/67.83	31.08/106.04	41.98/143.24	52.35/178.62

Air Velocity	Performance [KW/Btu/h×1000]							
[m/s]	R404A				R407C			
[ft/min]	Δ=10 K / 18 °F	Δ=15 K / 27 °F	Δ=20 K / 36 °F	Δ=25 K / 45 °F	Δ=10 K / 18 °F	Δ=15 K / 27 °F	Δ=20 K / 36 °F	Δ=25 K / 45 °F
1.0/197	8.64/29.48	13.36/45.58	17.95/61.25	22.55/76.94	5.81/19.82	10.71/36.54	15.33/52.31	20.04/68.38
1.5/295	12.2/41.63	19.13/65.27	25.7/87.69	32.36/110.41	8.16/27.84	15.24/52	22.14/75.54	28.81/98.3
2.0/394	15.9/54.25	24.41/83.29	32.75/111.74	41.27/140.81	10.21/34.84	19.27/65.75	28.26/96.42	36.68/125.15
2.5/492	19.04/64.96	29.09/99.26	39.18/133.68	49.39/168.52	12.04/41.08	23.48/80.11	33.87/115.56	43.92/149.86
3.0/591	21.91/74.76	33.41/113.99	44.95/153.37	56.83/193.9	13.68/46.68	27.05/92.29	39.05/133.24	50.58/172.58

Air-side Pressure Drop Data

Air Velocity	Pressure drop	Flow rate
[m/s]	[Pa] / [inch H ₂ O]	[m ³ /h] / [cfm]
[ft/min]		
1.0/197	18.3/0.07	2785.95/1638.79
1.5/295	30.6/0.12	4178.93/2458.19
2.0/394	45.1/0.18	5571.9/3277.59
2.5/492	61.8/0.25	6964.88/4096.99
3.0/591	80.6/0.32	8357.85/4916.38

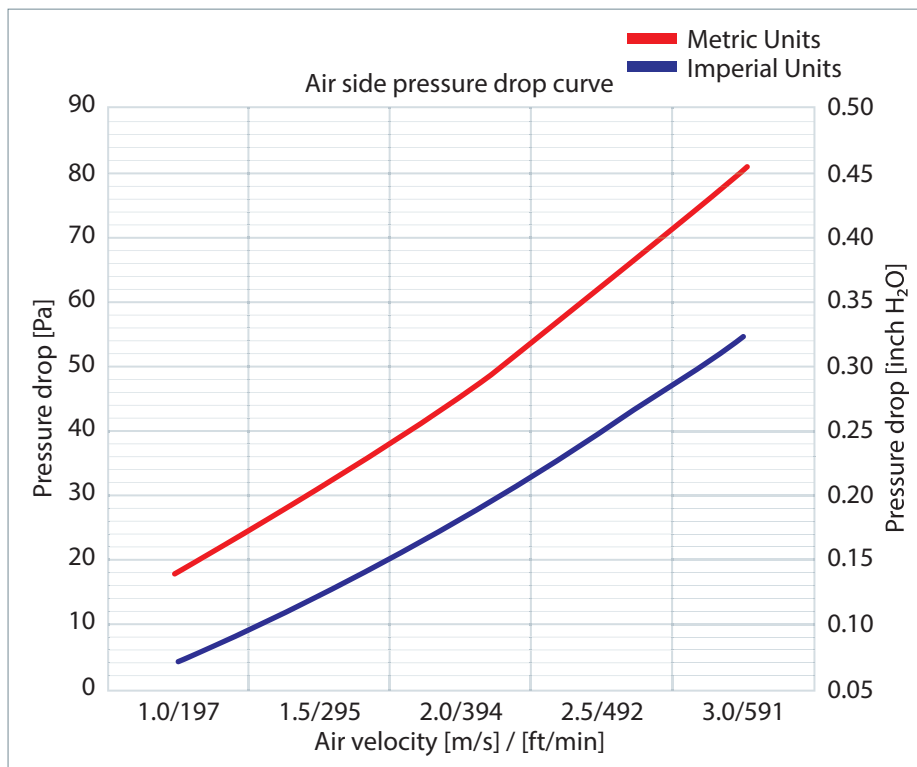

D1800-C Condenser coil

Micro-Channel Heat Exchanger

Drawing of Overall Dimensions

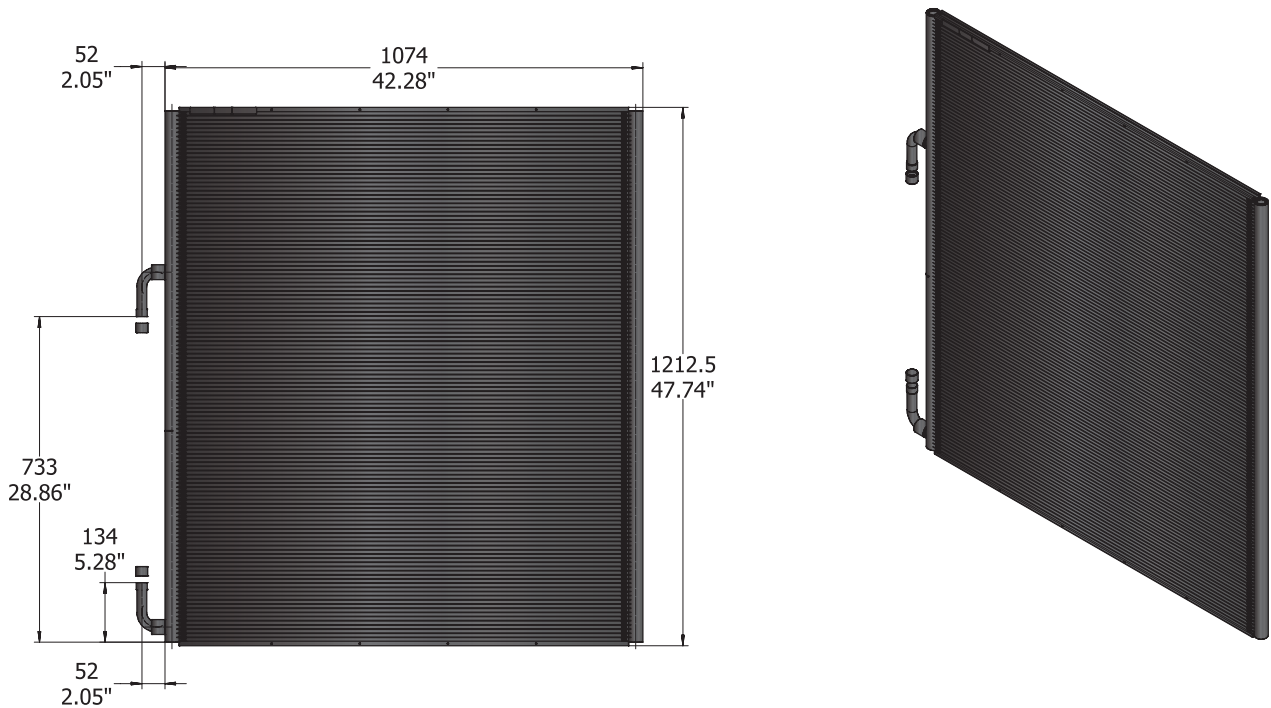

Technical Data

Model	Coil length	Coil height	Coil depth	Fin pitch	Fin height	Manifold diameter
D1800-C	1074 [mm]	1212.5 [mm]	25.4 [mm]	1.1 [mm]	8.1 [mm]	32 [mm]
	42.28 [in]	47.74 [in]	1 [in]	23 [FPI]	0.32 [in]	1.26 [in]
Model	Tubes height	Number of tubes	Internal volume	Coil weight	Inlet ID diameter	Outlet ID diameter
D1800-C	1.3 [mm]	126	2.79 [L]	15.139 [KG]	22.4 [mm]	22.4 [mm]
	0.05 [in]		170.19 [in ³]	33.31 [LB]	0.88 [in]	0.88 [in]

Mounting Bars

Aluminum MCHEs expand and contract when exposed to big temperature changes. Installation supports/brackets must allow the MCHE to move in two dimensions.

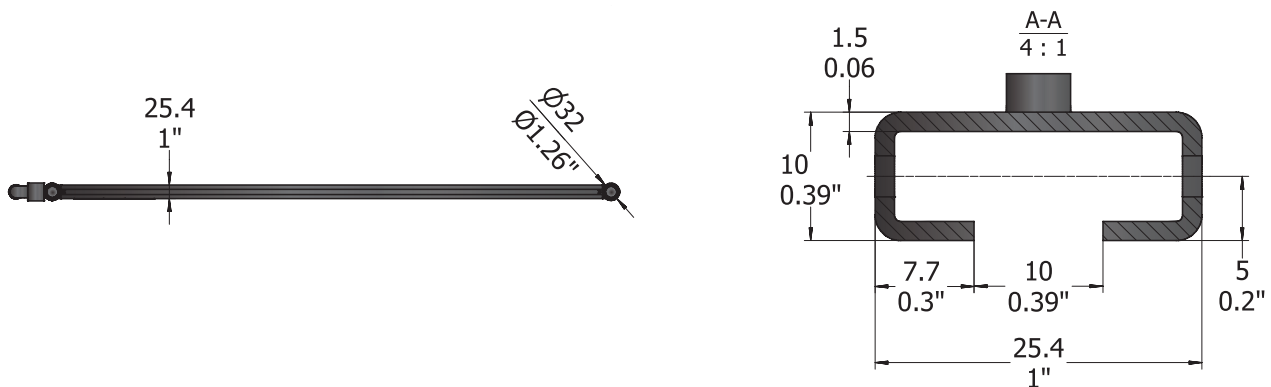

Performance Data

Air Velocity	Performance [KW/Btu/h×1000]							
[m/s]	R410A				R134a			
[ft/min]	Δ=10 K / 18 °F	Δ=15 K / 27 °F	Δ=20 K / 36 °F	Δ=25 K / 45 °F	Δ=10 K / 18 °F	Δ=15 K / 27 °F	Δ=20 K / 36 °F	Δ=25 K / 45 °F
1.0/197	13.27/45.28	20.25/69.09	27.19/92.77	34.64/118.19	12.81/43.71	19.5/66.53	26.16/89.26	32.8/111.91
1.5/295	18.92/64.56	28.92/98.68	39.64/135.25	49.98/170.53	18.09/61.72	27.66/94.38	37.2/126.93	46.72/159.41
2.0/394	24.03/81.99	37.61/128.33	50.8/173.33	64.18/218.98	22.79/77.76	34.97/119.32	47.12/160.77	60.21/205.44
2.5/492	28.69/97.89	45.3/154.56	61.18/208.75	77.34/263.88	27.02/92.19	41.56/141.8	57.01/194.52	71.99/245.63
3.0/591	32.99/112.56	52.36/178.65	70.86/241.77	89.68/305.99	30.84/105.23	47.55/162.24	65.58/223.76	82.09/280.09

Air Velocity	Performance [KW/Btu/h×1000]							
[m/s]	R404A				R407C			
[ft/min]	Δ=10 K / 18 °F	Δ=15 K / 27 °F	Δ=20 K / 36 °F	Δ=25 K / 45 °F	Δ=10 K / 18 °F	Δ=15 K / 27 °F	Δ=20 K / 36 °F	Δ=25 K / 45 °F
1.0/197	13.26/45.24	20.25/69.09	27.59/94.14	34.79/118.7	8.5/29	16.47/56.2	23.57/80.42	30.6/104.41
1.5/295	18.74/63.94	29.08/99.22	39.65/135.29	50.02/170.67	12.51/42.68	23.42/79.91	33.65/114.81	44.36/151.36
2.0/394	23.6/80.52	37.59/128.26	50.68/172.92	63.97/218.27	15.69/53.53	29.62/101.06	42.75/145.86	56.8/193.8
2.5/492	27.99/95.5	44.95/153.37	60.77/207.35	76.77/261.94	18.5/63.12	35.39/120.75	52.21/178.14	68.03/232.12
3.0/591	33.02/112.66	51.83/176.84	70.12/239.25	88.59/302.27	21.07/71.89	40.65/138.7	60.34/205.88	78.55/268.01

Air-side Pressure Drop Data

Air Velocity	Pressure drop	Flow rate
[m/s]	[Pa] / [inch H ₂ O]	[m ³ /h] / [cfm]
[ft/min]		
1.0/197	18.3/0.07	4293/2525.29
1.5/295	30.6/0.12	6439.5/3787.94
2.0/394	45.1/0.18	8586/5050.59
2.5/492	61.8/0.25	10732.5/6313.24
3.0/591	80.6/0.32	12879/7575.88

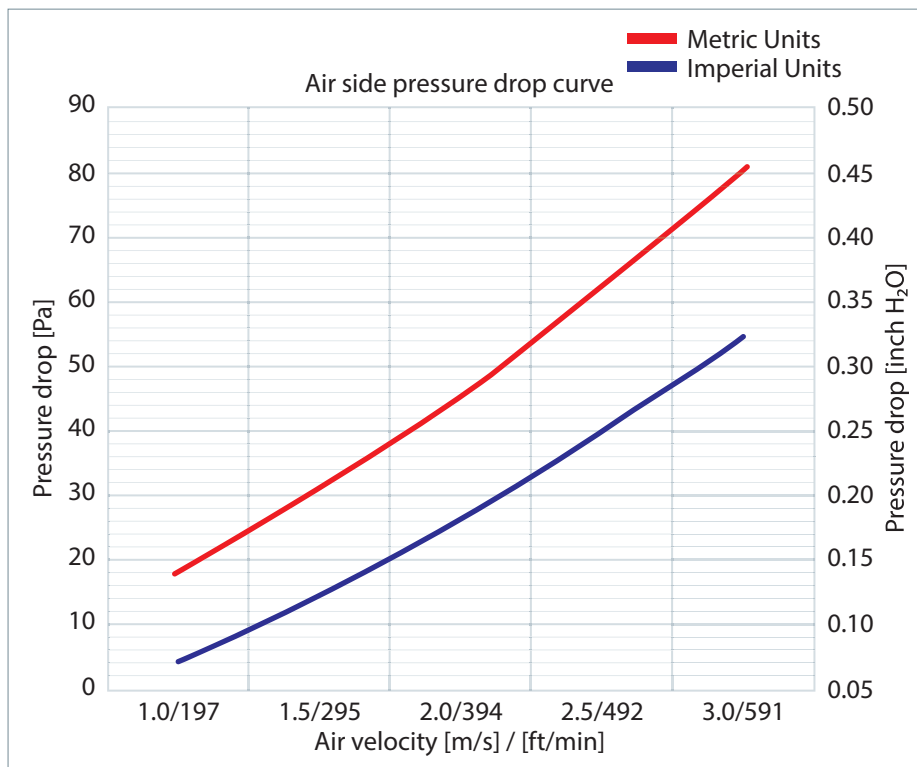

D1900-C Condenser coil

Micro-Channel Heat Exchanger

Drawing of Overall Dimensions

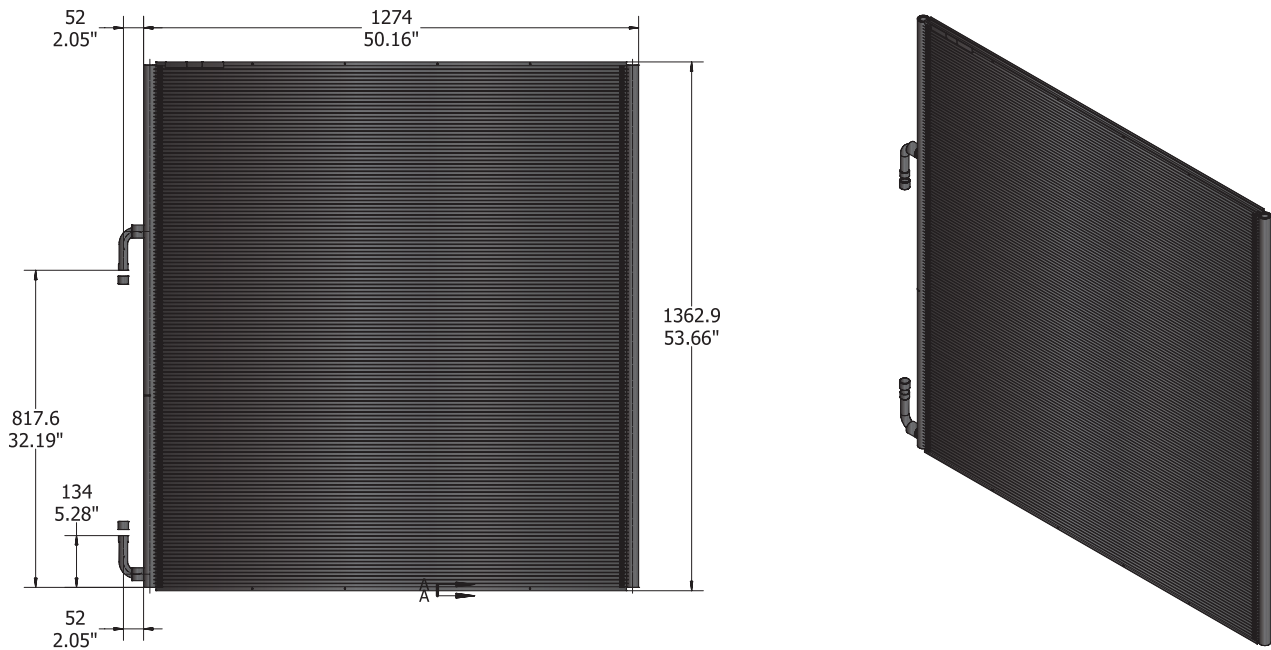

Technical Data

Model	Coil length	Coil height	Coil depth	Fin pitch	Fin height	Manifold diameter
D1900-C	1274 [mm]	1362.9 [mm]	25.4 [mm]	1.1 [mm]	8.1 [mm]	32 [mm]
	50.16 [in]	53.66 [in]	1 [in]	23 [FPI]	0.32 [in]	1.26 [in]
Model	Tubes height	Number of tubes	Internal volume	Coil weight	Inlet ID diameter	Outlet ID diameter
D1900-C	1.3 [mm]	142	3.49 [L]	19.88 [KG]	22.4 [mm]	22.4 [mm]
	0.05 [in]		212.89 [in³]	43.74 [LB]	0.88 [in]	0.88 [in]

Mounting Bars

Aluminum MCHEs expand and contract when exposed to big temperature changes. Installation supports/brackets must allow the MCHE to move in two dimensions.

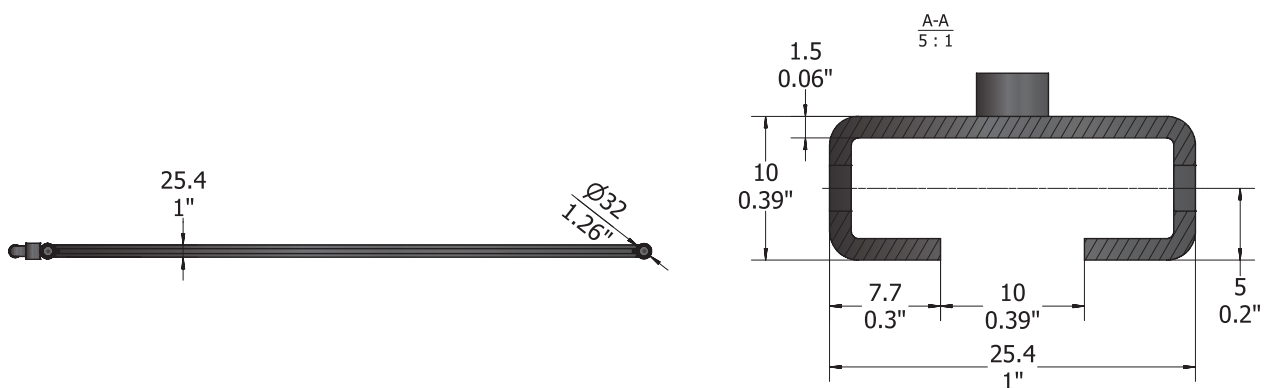

Performance Data

Air Velocity	Performance [KW/Btu/h×1000]							
[m/s]	R410A				R134a			
[ft/min]	Δ=10 K / 18 °F	Δ=15 K / 27 °F	Δ=20 K / 36 °F	Δ=25 K / 45 °F	Δ=10 K / 18 °F	Δ=15 K / 27 °F	Δ=20 K / 36 °F	Δ=25 K / 45 °F
1.0/197	18.1/61.76	27.5/93.83	37.27/127.17	46.91/160.06	17.33/59.13	26.34/89.87	35.31/120.48	44.27/151.05
1.5/295	25.81/88.06	39.93/136.24	53.68/183.16	67.65/230.82	24.42/83.32	37.28/127.2	50.11/170.98	63.59/216.97
2.0/394	32.78/111.85	51.12/174.42	68.76/234.61	86.71/295.85	30.68/104.68	47/160.36	64.08/218.64	80.63/275.11
2.5/492	40.18/137.09	61.34/209.29	82.7/282.17	104.36/356.08	36.25/123.69	55.72/190.12	76.24/260.13	95.23/324.92
3.0/591	46.35/158.15	70.93/242.01	95.65/326.36	120.72/411.9	41.28/140.85	64.53/220.18	87.27/297.77	108.75/371.06

Air Velocity	Performance [KW/Btu/h×1000]							
[m/s]	R404A				R407C			
[ft/min]	Δ=10 K / 18 °F	Δ=15 K / 27 °F	Δ=20 K / 36 °F	Δ=25 K / 45 °F	Δ=10 K / 18 °F	Δ=15 K / 27 °F	Δ=20 K / 36 °F	Δ=25 K / 45 °F
1.0/197	18.03/61.52	27.42/93.56	37.41/127.64	46.99/160.33	12.12/41.35	22.36/76.29	31.94/108.98	41.54/141.73
1.5/295	25.47/86.9	39.86/136	53.59/182.85	67.45/230.14	17.05/58.17	31.77/108.4	45.55/155.42	60.06/204.92
2.0/394	32.06/109.39	50.67/172.89	68.24/232.83	85.97/293.33	21.35/72.85	40.24/137.3	58.83/200.73	76.46/260.88
2.5/492	39.61/135.15	60.59/206.73	81.61/278.45	102.88/351.03	25.11/85.68	47.92/163.5	70.51/240.58	91.53/312.3
3.0/591	45.6/155.59	69.65/237.65	93.84/320.18	118.42/404.05	28.57/97.48	56.28/192.03	80.89/276	105.35/359.45

Air-side Pressure Drop Data

Air Velocity	Pressure drop	Flow rate
[m/s]	[Pa] / [inch H ₂ O]	[m ³ /h] / [cfm]
[ft/min]		
1.0/197	18.3/0.07	5801.33/3412.55
1.5/295	30.6/0.12	8701.99/5118.82
2.0/394	45.1/0.18	11602.66/6825.09
2.5/492	61.8/0.25	14503.32/8531.36
3.0/591	80.6/0.32	17403.98/10237.64

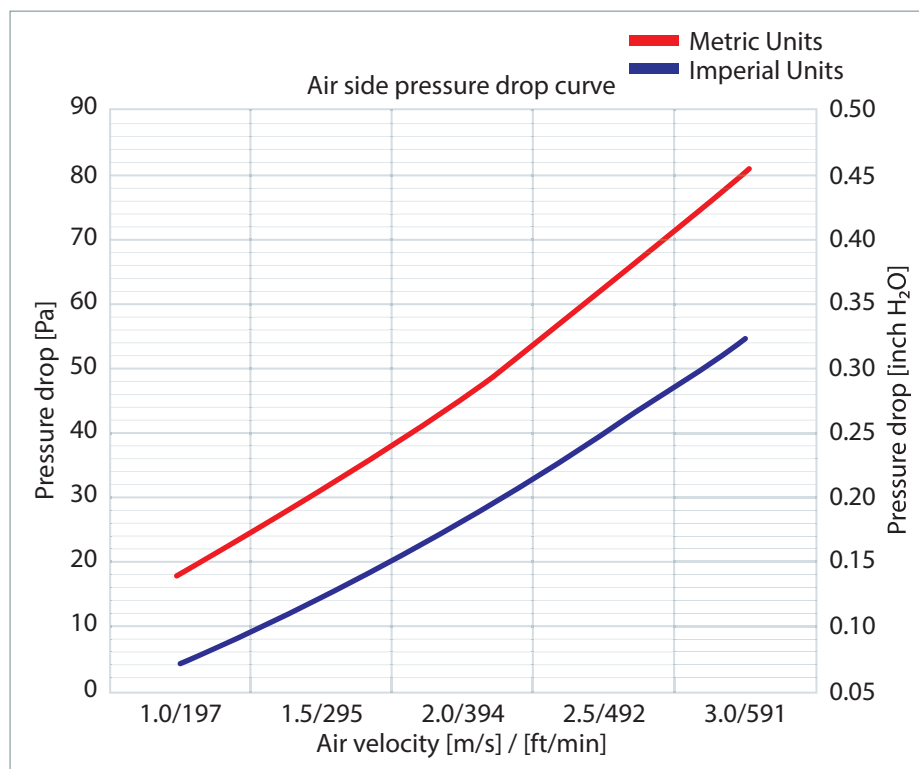

D2000-C Condenser coil

Micro-Channel Heat Exchanger

Drawing of Overall Dimensions

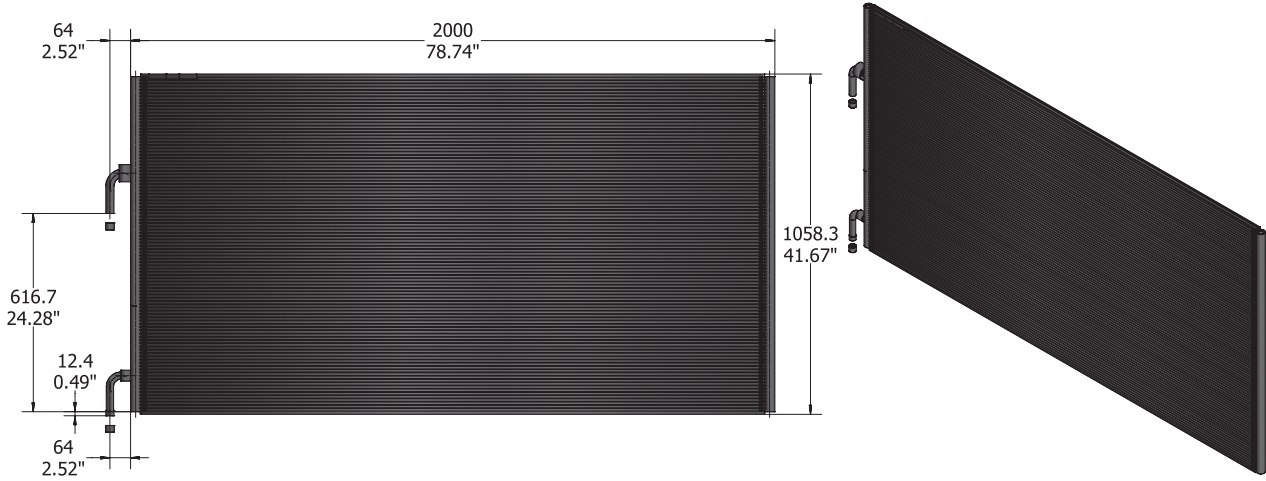

Technical Data

Model	Coil length	Coil height	Coil depth	Fin pitch	Fin height	Manifold diameter
D2000-C	2000 [mm]	1058.3 [mm]	25.4 [mm]	1.1 [mm]	8.1 [mm]	32 [mm]
	78.74 [in]	41.67 [in]	1 [in]	23 [FPI]	0.32 [in]	1.26 [in]
Model	Tubes height	Number of tubes	Internal volume	Coil weight	Inlet ID diameter	Outlet ID diameter
D2000-C	2 [mm]	102	5.44 [L]	26.273 [KG]	25.4 [mm]	22.4 [mm]
	0.08 [in]		331.84 [in ³]	57.8 [LB]	1 [in]	0.88 [in]

Mounting Bars

Aluminum MCHEs expand and contract when exposed to big temperature changes. Installation supports/brackets must allow the MCHE to move in two dimensions.

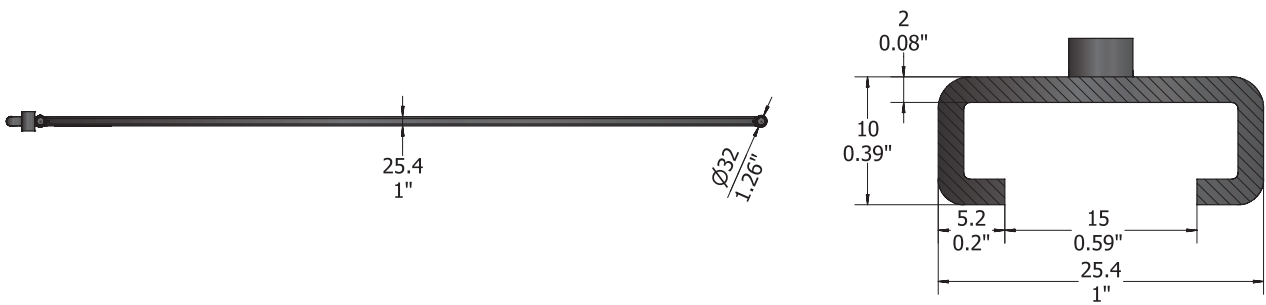

Performance Data

Air Velocity	Performance [KW/Btu/h×1000]							
[m/s]	R410A				R134a			
[ft/min]	Δ=10 K / 18 °F	Δ=15 K / 27 °F	Δ=20 K / 36 °F	Δ=25 K / 45 °F	Δ=10 K / 18 °F	Δ=15 K / 27 °F	Δ=20 K / 36 °F	Δ=25 K / 45 °F
1.0/197	22.66/77.32	34.85/118.91	46.82/159.75	58.88/200.9	21.92/74.79	33.22/113.35	44.83/152.96	56.24/191.89
1.5/295	33.06/112.8	50.49/172.27	67.85/231.5	85.42/291.45	31.13/106.22	48.02/163.84	64.5/220.07	80.99/276.34
2.0/394	42.5/145.01	64.89/221.4	87.4/298.21	110.18/375.93	39.36/134.3	61.3/209.16	82.37/281.05	102.95/351.27
2.5/492	51.27/174.93	78.32/267.23	105.58/360.24	133.2/454.48	46.77/159.58	73.36/250.3	97.98/334.31	123.15/420.19
3.0/591	59.52/203.08	90.96/310.36	122.63/418.41	154.83/528.28	55.06/187.86	84.43/288.08	112.51/383.88	141.52/482.87

Air Velocity	Performance [KW/Btu/h×1000]							
[m/s]	R404A				R407C			
[ft/min]	Δ=10 K / 18 °F	Δ=15 K / 27 °F	Δ=20 K / 36 °F	Δ=25 K / 45 °F	Δ=10 K / 18 °F	Δ=15 K / 27 °F	Δ=20 K / 36 °F	Δ=25 K / 45 °F
1.0/197	22.51/79.1	35.06/123.2	47.04/165.3	59.11/207.71	15.26/53.62	28.04/98.53	40.51/142.35	52.57/184.73
1.5/295	33.08/116.24	50.5/177.46	67.86/238.46	85.43/300.2	21.44/75.34	40.57/142.56	58.53/205.67	75.92/266.78
2.0/394	42.35/148.82	64.63/227.11	87.06/305.93	109.66/385.35	26.89/94.49	52.25/183.61	75.17/264.15	97.44/342.4
2.5/492	50.86/178.72	77.81/273.42	104.73/368.02	131.99/463.81	31.78/111.67	62.87/220.93	90.17/316.86	117.32/412.26
3.0/591	58.57/205.81	89.79/315.52	121.08/425.48	152.69/536.55	36.18/127.14	72.78/255.75	104.24/366.3	135.74/476.99

Air-side Pressure Drop Data

Air Velocity	Pressure drop	Flow rate
[m/s]	[Pa] / [inch H ₂ O]	[m ³ /h] / [cfm]
[ft/min]		
1.0/197	20.9/0.08	7199.16/4234.8
1.5/295	34.7/0.14	10798.74/6352.2
2.0/394	50.7/0.2	14398.31/8469.59
2.5/492	68.9/0.28	17997.89/10586.99
3.0/591	89.4/0.36	21597.47/12704.39

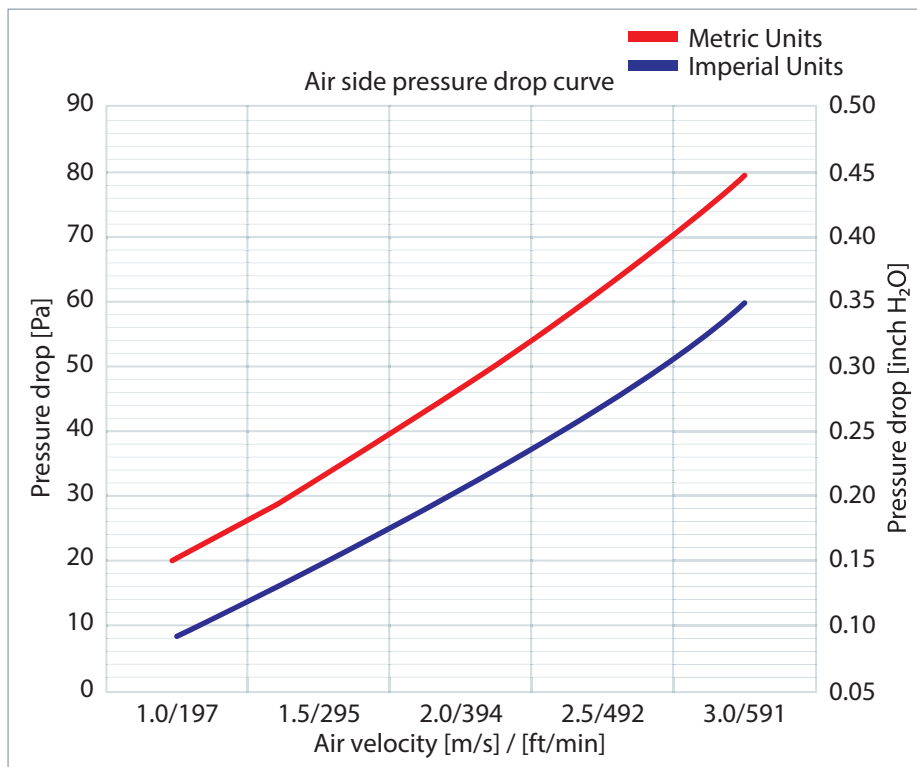

ENGINEERING
TOMORROW

Danfoss



Danfoss Micro Channel Heat Exchanger (Jia Xing) Co., Ltd.

Add: No. 8, Sangdelan Road,
Wuyuan Street, Haiyan,
Zhejiang Province 314300,
P.R.China

Website: <http://www.danfoss.com>

Danfoss can accept no responsibility for possible errors in catalogues, brochures and other printed material. Danfoss reserves the right to alter its products without notice. This also applies to products already on order provided that such alterations can be made without subsequential changes being necessary in specifications already agreed. All trademarks in this material are property of the respective companies. Danfoss and the Danfoss logotype are trademarks of Danfoss A/S. All rights reserved.